

No.	DESCRIPTION	MATERIAL
1	STEM	LOW LEAD BRASS ALLOY
2	O-RING	EPDM ASTM D2000
3	BALL	LOW LEAD BRASS ALLOY
4	GASKET - SEAL	NITRILE ASTM D2000
5	BODY	CAST LOW LEAD BRASS ALLOY
6	O-RING	EPDM ASTM D2000
7	END PIECE	CAST LOW LEAD BRASS ALLOY
8	COMP GSKT	NITRILE ASTM D2000
9	WASHER	POLYPROPYLENE
10	CPLG NUT	CAST BRASS ASTM B62 ALLOY C83600
11	CAP	CAST BRASS ASTM B62 ALLOY C83600
12	SOLID PIN	STAINLESS STEEL

SIZE	ØA	B	C	D
1"	1.000	4.918	1.178	2.829
1-1/2"	1.500	5.500	1.655	5.109
2"	2.000	6.835	1.820	5.612

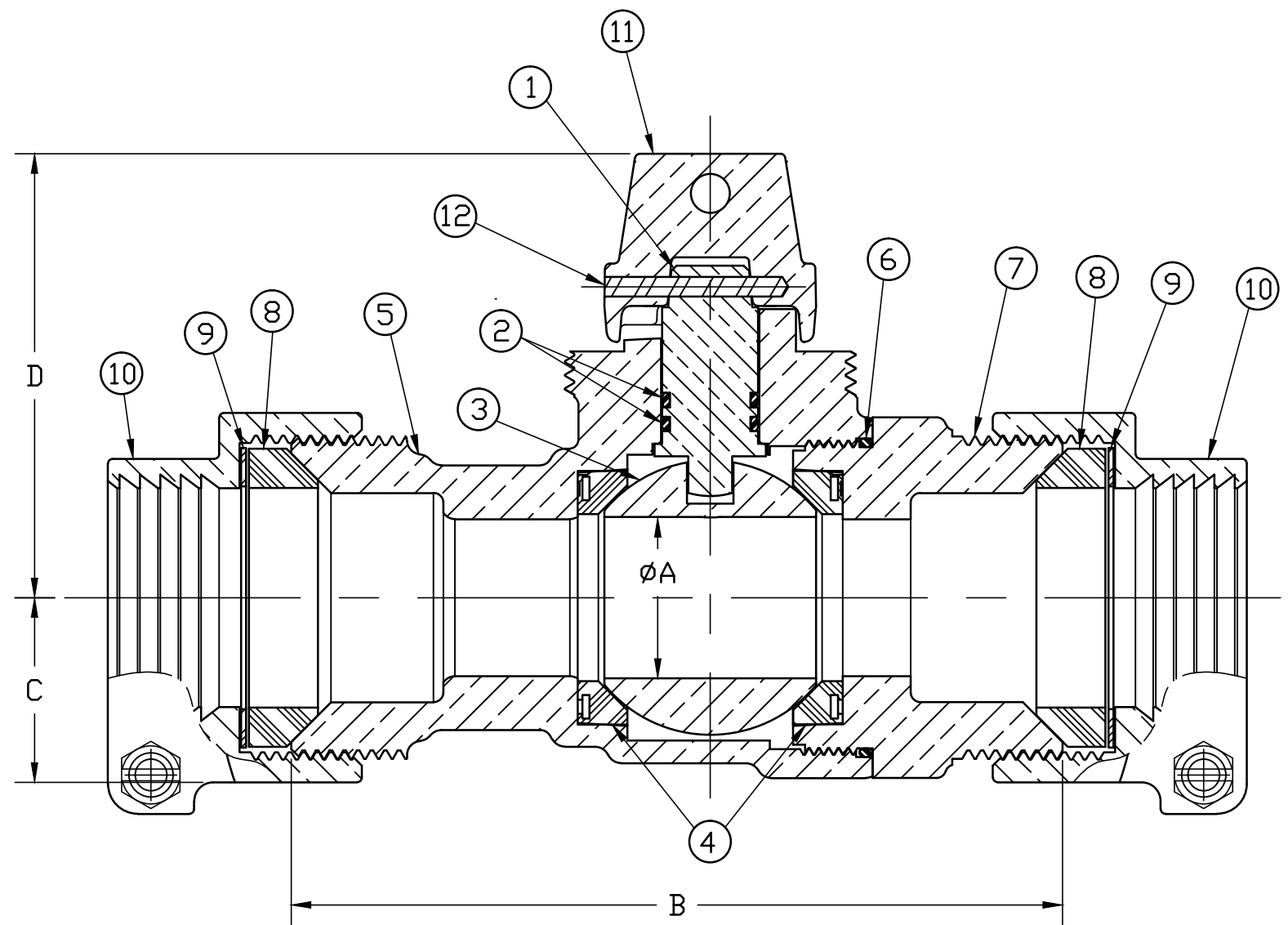

FILEPATH: PROD-ENG\MUELLER\APPROVED\V25109N

						DRFTR	RWB	4/11/17	Mueller Co.		
						CHKR					
						ENGR					
						MGR					
									UNLESS OTHERWISE NOTED	THIRD ANGLE PROJECTION	
									SURFACE PREPARATION:		
									BREAK CORNER(S) ---- .000		
									SURFACE FINISH -- XX RMS	REF. No.	SCALE
									TOLERANCE(S):		
									LINEAR ----- ± .000		
									ANGULAR ----- ± 0°00'		
									STK No:		
									MAT'L:		
									DESCR.	LLB BALL CORPORATION VALVE	DWG NUMBER
										(PJ IPS PVC x PJ IPS PVC)	V25109N
									PER EST NO: DXXXX	EST FIN WT = 0.0000 lbs	

ALL WETTED PARTS ARE LOW LEAD BRASS ALLOY

DWG NUMBER
V25109N

MRKTNG

TITLE TO AND OWNERSHIP OF THIS ENGINEERING DATA REMAINS IN Mueller Co. NO USE IS TO BE MADE OF THIS DATA EXCEPT AS SPECIFICALLY AUTHORIZED BY Mueller Co. ASSENT ON THE PART OF THE RECIPIENT TO THESE CONDITIONS IS PRESUMED