

No.	DESCRIPTION	MATERIAL DESCRIPTION
1	STEM	LOW LEAD BRASS ALLOY
2	O-RING	ASTM D2000 (EP)
3	BALL	LOW LEAD BRASS ALLOY
4	RUBBER GASKET	ASTM D2000 (NITRILE)
5	BODY	CAST LOW LEAD BRASS ALLOY
6	O-RING	ASTM D2000 (EP)
7	END PIECE	CAST LOW LEAD BRASS ALLOY
8	GASKET SUB	ASTM D2000(SBR)&410 STAINLESS STEEL
9	CONNX NUT	CAST BRASS ASTM B62 ALLOY C83600
10	CAP	CAST BRASS ASTM B62 ALLOY C83600
11	ROLLPIN	ASTM A240 TYPE 302

SIZE	ØA	B	C	D	E
3/4"	.75	3.62	1.84	.84	2.68
1"	1.00	4.65	2.08	1.15	3.23
1-1/2"	1.50	5.16	3.37	1.50	4.87
1-1/2x2"	1.50	5.13	3.37	1.50	4.87
2"	2.00	5.61	3.70	1.82	5.52

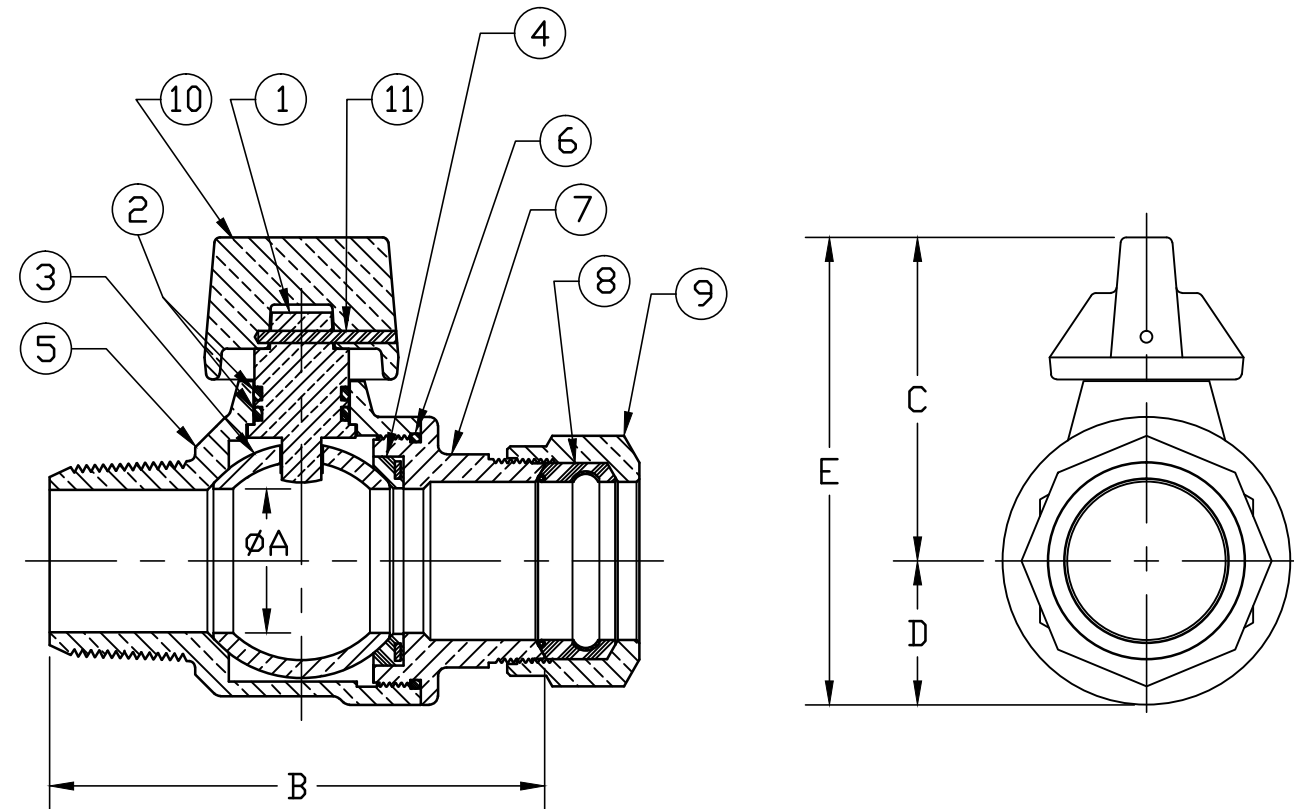

NOTE: ALL WETTED PARTS ARE LOW LEAD BRASS ALLOY

FILEPATH: PROD-ENG\MUELLER\ASYSUBMITTALS\B2500810N

DRFTR	JGarvin	8/19/11	Mueller Co.		
CHKR					
ENGR					
MGR					
			UNLESS OTHERWISE NOTED	THIRD ANGLE PROJECTION	
			SURFACE PREPARATION:		
			BREAK CORNER(S) ---- .000		
			SURFACE FINISH -- XX RMS	REF. No.	
			TOLERANCE(S):	SCALE	
			LINEAR ----- ± .000	NONE	
			ANGULAR ----- ± 0°00'		
			STK No:		
			MAT'L:		
			DESCR.		
			BALL CORPORATION VALVE w/ CAP	DWG NUMBER	
			LOW LEAD BRASS(CC x 110CTS)	B2500810N	
REV	ECR	DESCRIPTION	DATE	BY	CHKR
PER EST NO: DXXXX EST FIN WT = 0.0000 lbs					

DWG NUMBER
B2500810N

442-MRKTG

TITLE TO AND OWNERSHIP OF THIS ENGINEERING DATA REMAINS IN Mueller Co. NO USE IS TO BE MADE OF THIS DATA EXCEPT AS SPECIFICALLY AUTHORIZED BY Mueller Co. ASSENT ON THE PART OF THE RECIPIENT TO THESE CONDITIONS IS PRESUMED