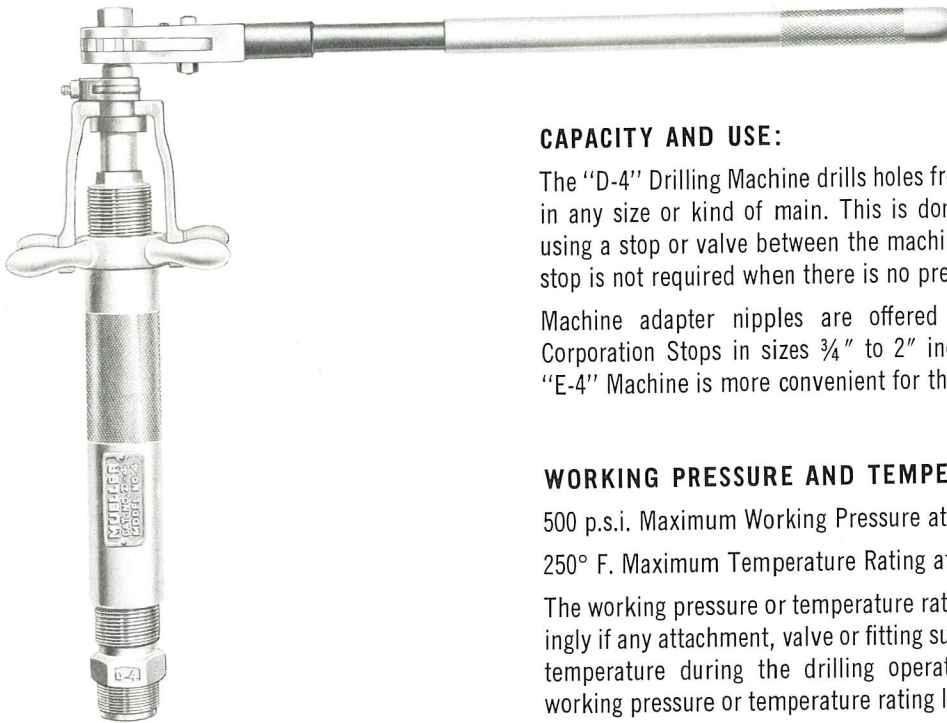

"D-4" DRILLING MACHINE

FOR DRILLING OPERATIONS $\frac{5}{8}$ " TO 2" INCLUSIVE UNDER PRESSURE

**CAPACITY AND USE:**

The "D-4" Drilling Machine drills holes from $\frac{5}{8}$ " to 2" inclusive in any size or kind of main. This is done under pressure by using a stop or valve between the machine and the main. The stop is not required when there is no pressure.

Machine adapter nipples are offered for drilling through Corporation Stops in sizes $\frac{3}{4}$ " to 2" inclusive; however, the "E-4" Machine is more convenient for the $\frac{3}{4}$ " size.

WORKING PRESSURE AND TEMPERATURE:

500 p.s.i. Maximum Working Pressure at 100° F.

250° F. Maximum Temperature Rating at 375 p.s.i.

The working pressure or temperature rating is reduced accordingly if any attachment, valve or fitting subjected to pressure or temperature during the drilling operation has a maximum working pressure or temperature rating less than that specified above.

LENGTH OF TRAVEL: 14"

EQUIPMENT FURNISHED WITH EACH MACHINE:

- Ratchet Handle
- Body Gasket
- Adjustable Wrench
- Double Open End Wrench
- Lubricating Oil
- Cutting Grease
- Metal Case

EQUIPMENT TO BE SELECTED:

Drill and Drill Holder from Page 2-7.

Machine Adapter Nipple from Page 2-8.

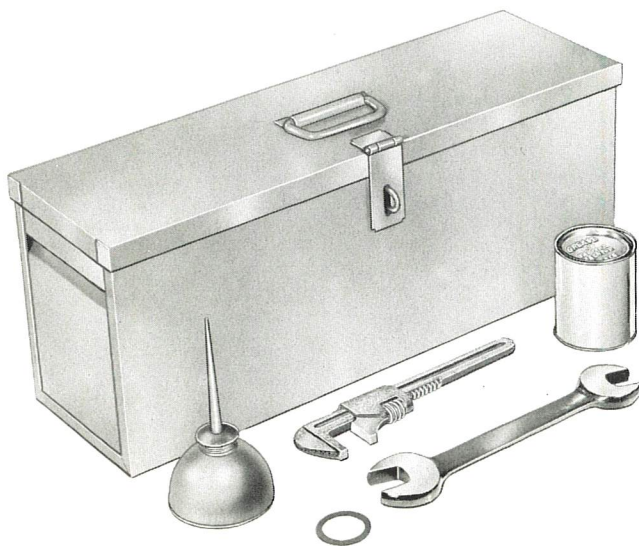
**"D-4" MACHINE AND EQUIPMENT FURNISHED**

Furnished in a Metal Carrying Case.

Total Shipping Weight: 59 pounds

Machine weight only: 38 pounds

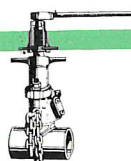

"D-4" MACHINE DRILLS AND DRILL HOLDERS

DRILLING MACHINES

The maximum drill size is specified for each Corporation Stop in Section 3. Smaller size drills may be used if desired. Drill and drill holder are furnished as separate parts in all sizes listed.

SIZE	DRILL			DRILL HOLDER
	Regular	CEM-RES	Tungsten Carbide Tipped	
5/8"	61982		83436	36998
11/16"	61992	36037	83142	36998
3/4"	61790	36038		36915
7/8"	61990	33253		37032
15/16"	61989	36039	83143	37032
1"	33529	36229	83163	33555
1 1/16"	33530			33555
1 1/8"	33531	33254		33555
1 3/16"	33532	74878	83192	33555
1 1/4"	33533	36041		33316
1 5/16"	33534			33316
1 3/8"	33535	33274		33316
1 7/16"	33536	36056	83144	33316
1 1/2"	33537	33904		33316
1 5/8"	33538			33314
1 3/4"	33539	33275	83145	33314
1 7/8"	33540	36069	83193	33314
2"	33541	36407		33314



DRILL HOLDER



DRILL

REGULAR Drills are for use with cast iron pipe and steel pipe.

CEM-RES Drills are for use with asbestos-cement pipe and cement-lined pipe.

TUNGSTEN CARBIDE TIPPED Drills are for use with concrete pipe. They may also be used for asbestos-cement pipe.

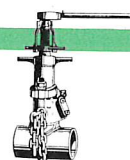

The Machine Adapter Nipples listed on this page are used between the lower end of the "D-4" Drilling Machine and the outlet end of the Corporation Stop.



COPPER
COUPLING THREAD



MUELLER THREAD



LEAD FLANGE
EXTRA STRONG



LEAD FLANGE
DOUBLE EXTRA STRONG



INSIDE
I.P. THREAD



OUTSIDE
I.P. THREAD

Type of Machine Adapter Nipple (also see Section 3)	Maximum Pressure & Temperature Rating	Size of the Outlet Pipe Connection of the Corporation Stop to be Used					
		3/4"	1"	1 1/4"	1 1/2"	2"	2 1/2"
With Inside Thread for Copper Coupling (MUELLER Copper Service Pipe Coupling)	200 p.s.i. at 100° F.	37902	37903	37904	37905	37906	
With Inside MUELLER Thread	200 p.s.i. at 100° F.	61165	77375				
With Inside Thread for Lead Flange Coupling for Extra Strong Lead Pipe	200 p.s.i. at 100° F.	63663	33895	73106	75431	75432	
With Inside Thread for Lead Flange Coupling for Double Extra Strong Lead Pipe	200 p.s.i. at 100° F.		74155	74156	63662	62174	
With Inside I.P. Thread	1200 p.s.i. at 100° F. 500° F. at 1000 p.s.i.	36910	36911	36912	36913	36525	36526
With Outside I.P. Thread	1200 p.s.i. at 100° F. 500° F. at 1000 p.s.i.	33556	36323	36195	36196	36188	36975
Inside Diameter of Nipple		23/32"	1 1/64"	1 9/32"	1 15/32"	1 15/16"	2 1/4"
Maximum Drill Size *		1 1/16"	1"	1 1/4"	1 7/16"	1 7/8"	2 1/8"
With Inside Thread for I.P. Threaded Copper Coupling (See Section 13)	1200 p.s.i. at 100° F. 500° F. at 1000 p.s.i.	45380	51104	46702			

*This is the maximum drill size which can be used with these machine adapter nipples having Outside I.P. Threads.

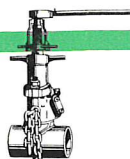

"D-4" MACHINE PARTS-MODEL NO. 4

DRILLING MACHINES

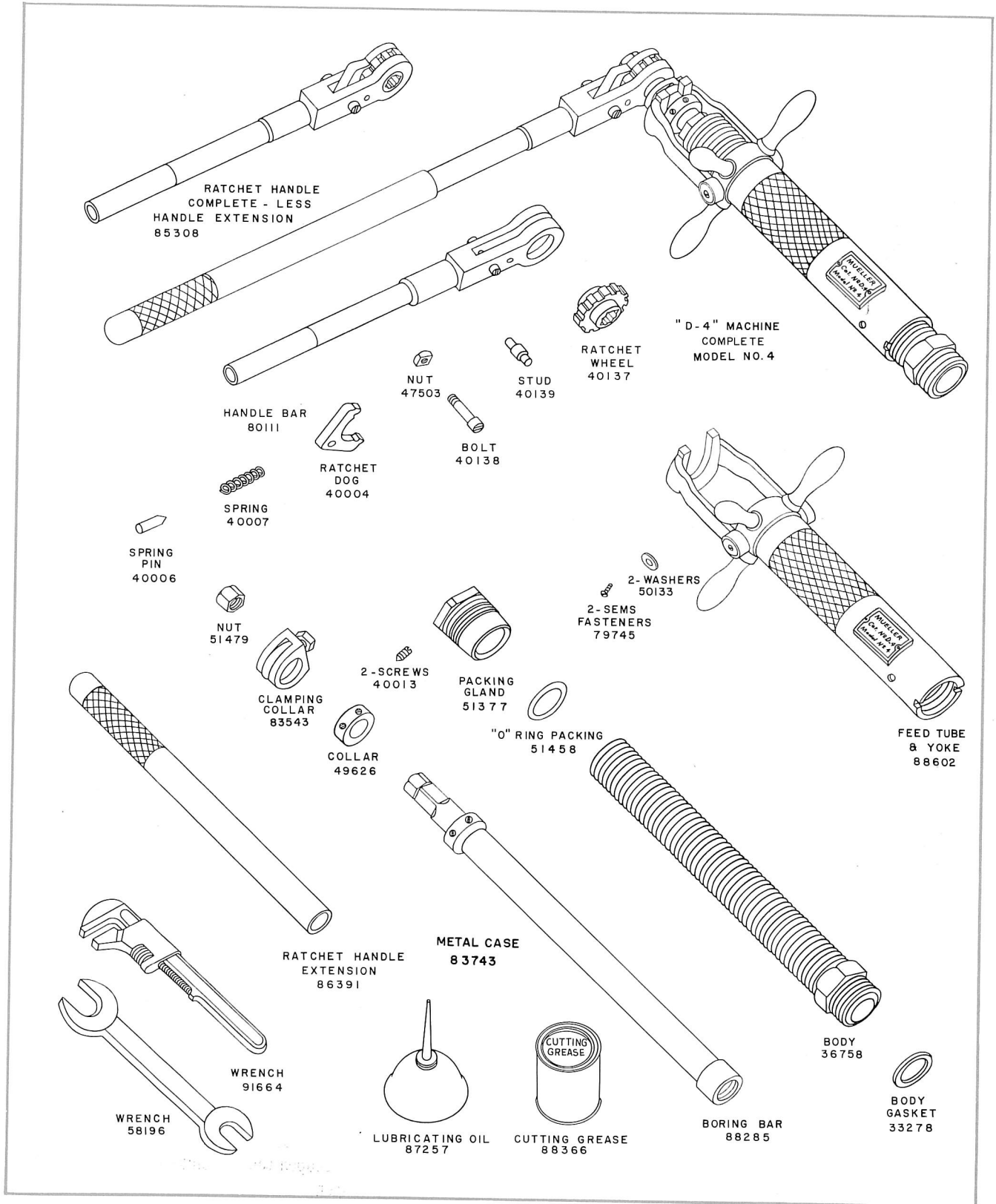

ORDER BY QUANTITY, PART NUMBER, PART NAME, CATALOG NUMBER AND MODEL NUMBER OF MACHINE

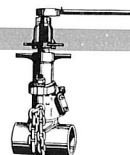

**MUELLER CO.
DECATUR, ILL.**