

# MUELLER® 5-1/4" FLUSH TYPE FIRE HYDRANT

**Mueller Co.**

**9.21**

Rev. 4-14

## MUELLER Super Centurion Fire Hydrant Parts

Catalog Part No.	Description	Material	Material Standard
1	Flush Box Lid (non-locking)	Cast Iron	ASTM A126 CL.B
2	Lift Handle	Steel	ASTM A-576 Grade M1020
3	Lift Handle Nut	Steel	-
4	Flush Box	Cast Iron	ASTM A126 CL.B
5	Pumper Nozzle Cap	Cast Iron	ASTM A126 CL.B
6	Pumper Nozzle Gasket	Rubber	ASTM D2000 - Neoprene
7	Pumper Nozzle	Bronze	ASTM B584
8	Hose Nozzle Cap	Cast Iron	ASTM A126 CL.B
9	Hose Nozzle Gasket	Rubber	ASTM D2000 - Neoprene
10	Hose Nozzle	Bronze	ASTM B584
11	Oil Screw for Operating Nut	Brass	ASTM B36
12	Operating Nut	Bronze	ASTM B584
13	Oil Screw in Hold Down Nut	Brass	ASTM B36
14	Hold Down Nut	Bronze	ASTM B584
15	Upper Barrel	Cast Iron	ASTM A126 CL.B
16	Hold Down Nut O-ring	Rubber	ASTM D2000 - Neoprene
17	O-ring Seal	Rubber	ASTM D2000 - Neoprene
18	Cap Screw	Steel	-
19	Barrel Flange Gasket	Rubber	ASTM D2000 - Neoprene
20	Lower Barrel	Cast Iron	ASTM A126 CL.B
21	Stem	Steel	ASTM A576 GR.B
22	Upper Valve Plate	Bronze	ASTM B584
23	Drain Valve Facing	HD Polyethylene	LS 5660-00
24	Drain Valve Facing Screw	Stainless Steel	ASTM A276
25	Seat Ring	Bronze	ASTM B584
26	Shoe Bolt and Nut	Steel	SAE J429 Grade 2
28	Stem Pin	Stainless Steel	-
29*	Main Valve 2006 and newer models for reversible main valve; pre-2006 models have non-reversible main valve and lower valve plate - not shown	Rubber	ASTM D2000 - SBR
30	Lower Valve Plate 2006 and newer models for reversible main valve; pre-2006 models have non-reversible main valve and lower valve plate - not shown	Cast Iron	ASTM A126 CL.B
31	Valve Plate Nut	Cast Iron	ASTMA126 CL.B
32	Cap Nut Seal	Rubber	ASTM D2000 - Natural
33	Lock Washer	Stainless Steel	ASTMA126 (302)
34	Drain Ring	Bronze	ASTM B584
35	Drain Ring Housing	Cast Iron	ASTMA126 CL.B
36	Shoe	Cast Iron	ASTMA126 CL.B
37	Pumper Nozzle O-ring	Rubber	ASTM D2000 - BUNA N
38	Hose Nozzle O-ring	Rubber	ASTM D2000 - BUNA N
39	Nozzle Lock	Stainless Steel	ASTMA126 (305 or 410)
40	Chain Hook	Steel	Electro Galvanized
41	Chain	Steel	ASTMA467-64
42	Top Seat O-ring	Rubber	ASTM D2000 - BUNA N
43	Bottom Seat O-ring	Rubber	ASTM D2000 - BUNA N
44	Drain Ring O-ring	Rubber	ASTM D2000 - BUNA N

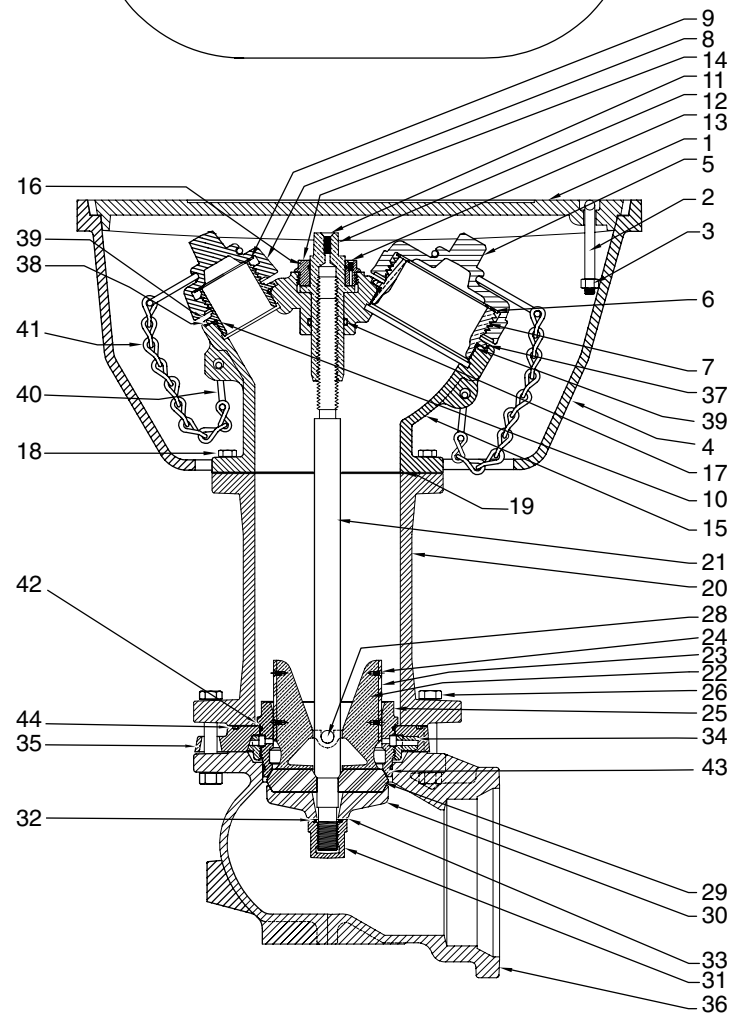
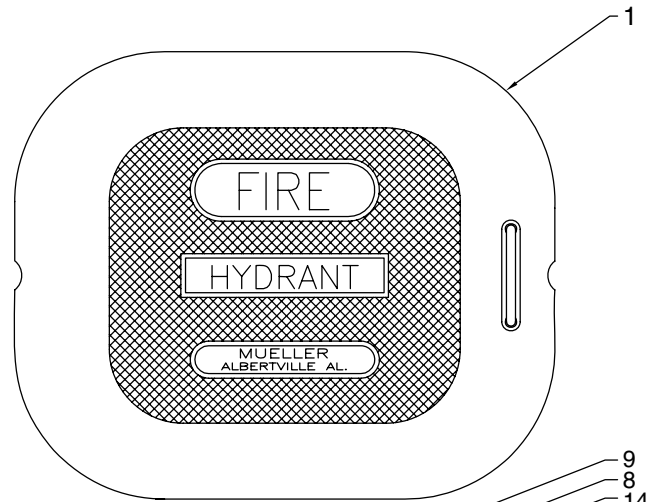

\* Pre-1997 models may be upgraded to use the reversible main valve by also replacing the lower valve plate with the 1997 model.

SEE PAGE 9.28 FOR ORDERING INSTRUCTIONS