

# MUELLER® LINESEAL III® BUTTERFLY VALVES CLASS 150B 12", 16" - SL. X FL.



# 11.7

Rev. 9-09

## Dimensions - for Line Seal III Valves Slip-on by Flanged Ends (Class 125), 12", 16" Sizes.

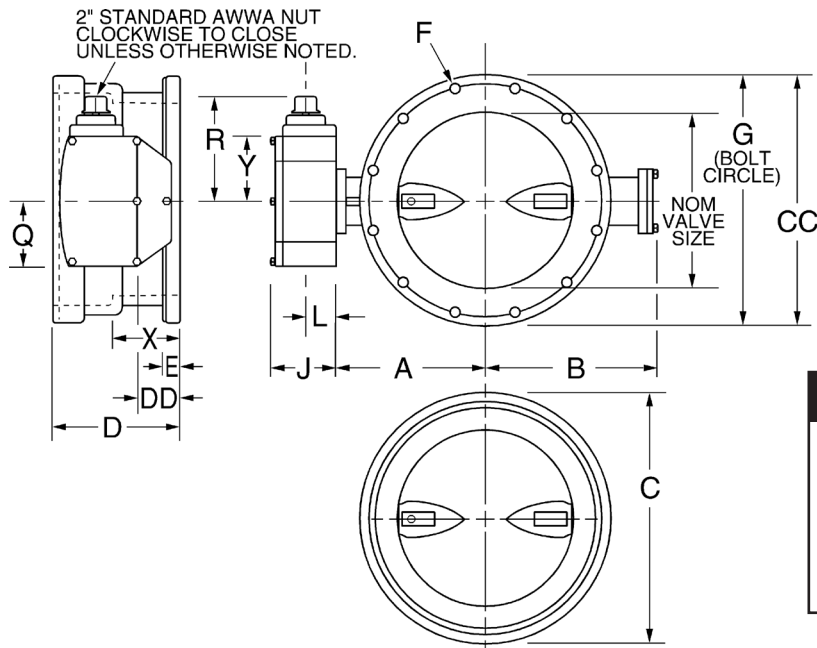

**CAUTION**  
When using 12" Valves on Class 200 PVC Pipe, pipe end I.D. must be bevelled to ensure clearance for disc and proper valve operation. Contact your Mueller Sales Representative for detailed instructions.

**Notes:** These dimensions are correct at time of publication but are not to be construed as certified drawings. Certified drawings available upon request.  
Actuator size subject to change based on actual pipeline conditions.

	Pipe size	
	12"	16"
Pipe O.D.	13.20	17.40

Dimension+	Nominal size	
	12"	16"
A	10.50	13.50
B	11.38	13.88
C (Slip on end)	16.38	21.25
CC (Flanged end)	19.00	23.50
D	11.50	11.50
DD	4.00	4.00
E	1.25	1.44
F (number and size of holes)	12--.88	16--1.00
G	17.00	21.25
J	4.69	5.63
L	2.00	2.44
Q	4.50	5.38
R	8.25	10.38
X (Laying length)	6.56	9.19
Turns to open	32	30
Actuator (see notes)	MDT-2S	MDT-3S

+ All dimensions are in inches.

- IMPORTANT:**
- Slip On end of this valve NOT FOR USE with IPS O.D. Pipe.
  - Slip On end of this valve for use with Tyton™ Rubber Ring Gasket (Tyton is a registered Trade Mark of U.S. Pipe & Foundry Co.).