

Features Of All Styles Of Mueller® Bronze Saddles For O.D. Controlled PVC Pipe

- ❑ **THICK TAPPING BOSS** – and precision machined, full length threads to provide a pressure-tight connection that resists pull-out. Generous wrenching surfaces to provide sure grip while installing corporation valve.



- ❑ **NITRILE O-RING SEALED** – glued in place and confined in a groove to resist cold-flow or distortion and provide a pressure tight seal against the main.

- ❑ **SILICON BRONZE SCREWS** – for strength and corrosion resistance (also hinge pin on swing hinge style).

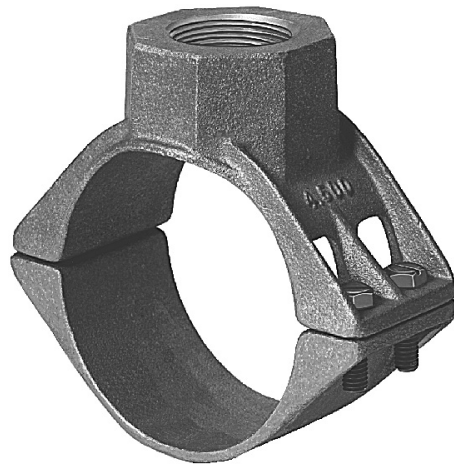

- ❑ **WIDE STRAP** – is specially shaped to fit the contour of the O.D. controlled plastic main and seal dependably without pipe distortion. Double-wide straps on saddles with 1-1/2" or 2" tapped outlets for added stability.

- ❑ **MANUFACTURED AND TESTED** – in accordance with all applicable parts of ANSI/AWWA C800-NSF 61 Certified.

