

## TELL-TALE™ BREAK CHECK VALVE



Cutaway  
shown  
for details

### PRODUCT FEATURES

- Breaks cleanly and reliably with traffic impact.
- Minimizes physical damage and water loss.
- Minimizes water hammer when activated.
- Small “Tell-Tale” water stream signals damage, insufficient to cause property damage.
- Does not affect normal Hydrant use or operation.
- Adapts to new or existing Jones® brand Hydrants.
- Tall or short vertical flanged inlet and elbow styles.
- Available 6 or 8 bolt-hole vertical flanged inlet pattern.
- Also available as 90° Shoe, with Flanged, MJ, Mueller® AquaGrip®, or Slip-On Inlet configurations.
- Easy to reset (no springs).
- Ductile Iron, Bronze, and Stainless Steel construction.
- Extension kits available 6” – 24” (150mm – 600mm).

### PARTS LIST

| ID | PART NAME                 | MATERIAL                  |
|----|---------------------------|---------------------------|
| 1  | Lower Valve Plate         | Cast Iron                 |
| 2  | Upper Valve Plate         | ASTM B584 Copper          |
| 3  | Drain Ring Housing        | Cast Iron                 |
| 4  | O-Rings                   | Nitrile                   |
| 5  | Hydrant Seat Ring         | ASTM B584 Copper          |
| 6  | Break Check Stem          | Stainless Steel           |
| 7  | Hydrant Drain Ring        | ASTM B584 Copper          |
| 8  | Adapter Plate             | Epoxy Coated Cast Iron    |
| 9  | Threaded Studs            | Zinc-Plated Steel         |
| 10 | Nuts (Adapter Plate)      | Zinc-Plated Steel         |
| 11 | Break Check Retaining Bar | Stainless Steel           |
| 12 | Traffic Flange Plates     | Cast Iron                 |
| 13 | Lower Barrel              | Epoxy Coated Cast Iron    |
| 14 | Bolts (Lower Barrel)      | Stainless Steel 304       |
| 15 | Nuts (Lower Barrel)       | Stainless Steel 304       |
| 16 | Main Reversible Valve     | Rubber (SBR)              |
| 17 | Vertical Shoe             | Epoxy Coated Ductile Iron |

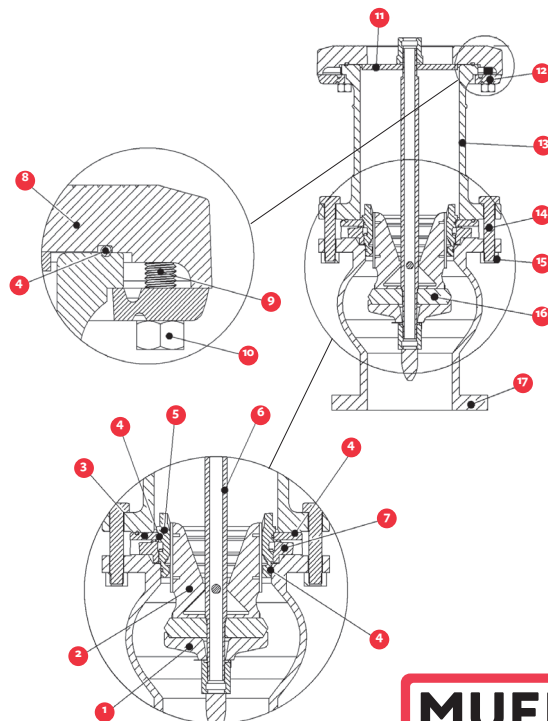

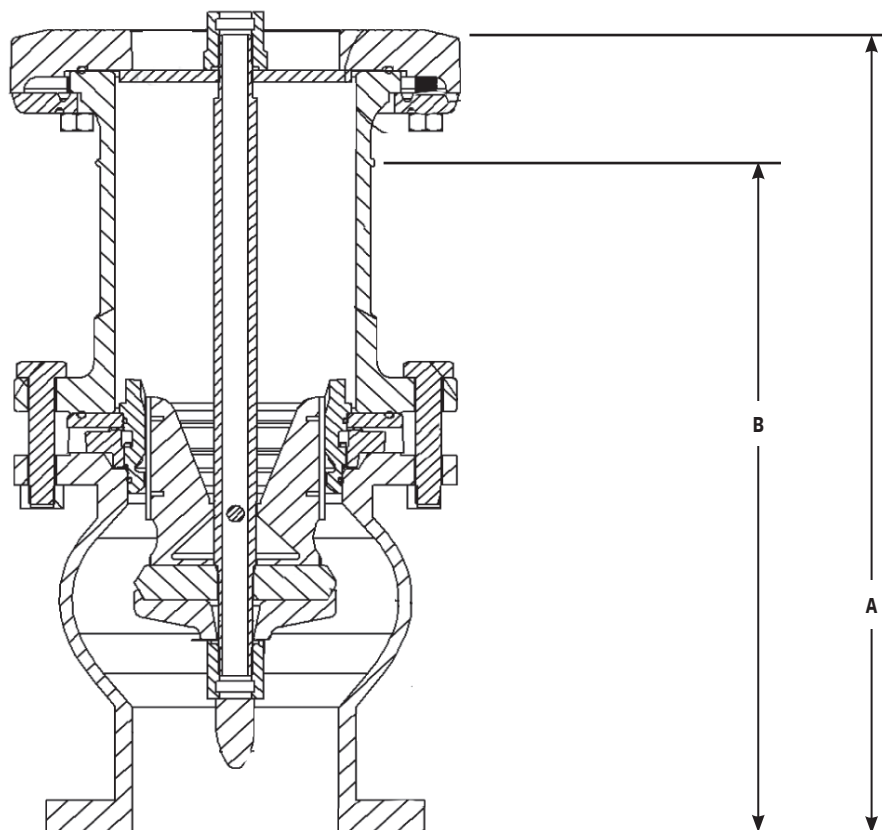

| A                          | B (BURY)                     |
|----------------------------|------------------------------|
| 25 $\frac{3}{8}$ " (645mm) | 21 $\frac{3}{16}$ " (538mm)  |
| 21" (533mm)                | 16 $\frac{13}{16}$ " (427mm) |

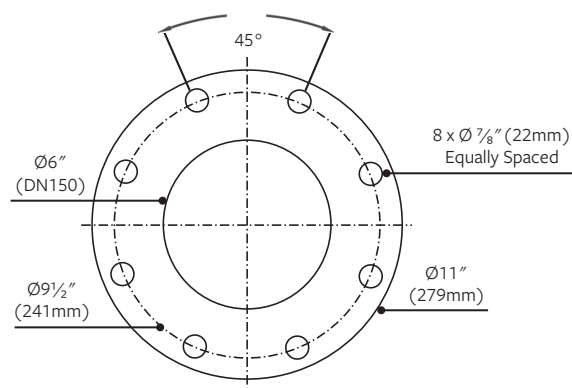
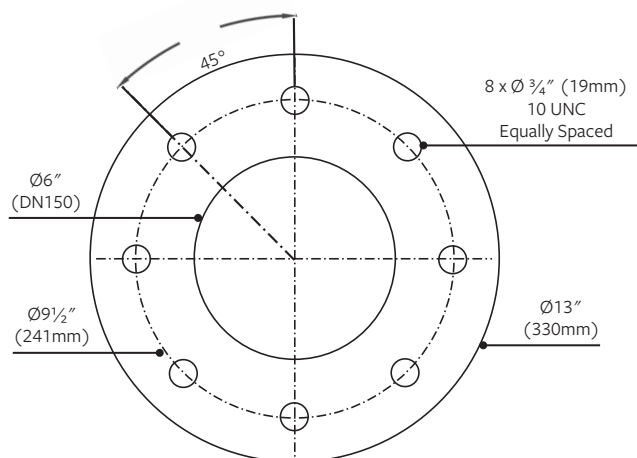

For more information about us, or to view our full line of products, please visit [www.mueller-international.com](http://www.mueller-international.com) or call International Customer Service at:

UK: +44.1438.487410 Dubai: +971.4.214.6640 Singapore: +65.6816.3088 USA: +1.800.423.1323 | [International@muellerwp.com](mailto:International@muellerwp.com)

Mueller refers to one or more of Mueller Water Products, Inc., a Delaware corporation ("MWP"), and its subsidiaries. MWP and each of its subsidiaries are legally separate and independent entities when providing products and services. MWP does not provide products or services to third parties. MWP and each of its subsidiaries are liable only for their own acts and omissions and not those of each other. MWP brands include Mueller®, Echologics®, Hydro Gate®, Hydro-Guard®, Jones®, Krausz®, MiNet®, Milliken®, Pratt®, Pratt Industrial®, Singer®, and U.S. Pipe Valve & Hydrant. Please see [muellerwp.com/brands](http://muellerwp.com/brands) to learn more.

© 2020 Mueller Water Products, Inc. All Rights Reserved. The trademarks, logos and service marks displayed in this document are the property of Mueller Water Products, Inc., its affiliates or other third parties. Products above marked with a section symbol (§) are subject to patents or patent applications. For details visit [www.mwppat.com](http://www.mwppat.com).

F 12743 3/20

**MUELLER**