



VALVE & HYDRANT

SENTINEL® 250 FIRE HYDRANT

PRODUCT FEATURES



- 3-way Hydrant: 250psig/17barg maximum working pressure, 500psig/34barg test pressure.
- UL Listed and FM approved. UL 246 and FM 1510 specifications.
- Meets or exceeds all applicable requirements of ANSI/AWWA C502 Standard.
- Stem - E-Coated for Corrosion Resistance.
- O-ring sealed Bonnet and Ground Coupling – better leak resistance, easier maintenance.
- Lubrication port in top of Revolving Nut to allow easy injection of lubricating grease – standard plug can be replaced with Zerk fitting for added convenience.
- Patented Reversible, Encapsulated Compression-Type Main Valve - closes with pressure for positive seal. Rubber material has long service life, yet is reversible, providing a convenient spare in the Hydrant.
- Positive lubrication of Stem threads and bearing surfaces each time Hydrant is operated. The revolving nut has 3 channels to distribute lubricating grease to Stem threads and both sides of thrust collar each time Hydrant is operated to assure easy operation.
- Full flow performance – large radius Hose and Pumper openings and conical Upper Valve Plate reduce turbulence and provide low friction loss.
- Bury Depth Tag - Attached to the Chain, provides instant Bury-Depth information.
- Field replaceable, O-ring sealed Hose and Pumper Nozzles – threaded in place and retained by stainless steel locks –NST or BSP threads.
- O-ring sealed Bronze Seat Ring – resists corrosion and easily removed for maintenance through top of Hydrant.
- Traffic Coupling and Stainless Steel Stem Coupling – if Hydrant is struck by vehicle, the Coupling breaks, preventing damage to stem and main valve, and uncontrolled Water flow – Coupling will not break into pieces that could drop down and affect Valve operation. Reusable Clip is easy to use. Repair is simple and economical.
- Double Bronze Drains – each time main valve opens or closes, drain valves force flush drain openings to keep them open for effective barrel drainage.
- Inlet Connections: 6"/DN150 Flanged ANSI B16.1 Class 125 Flat Face (optional PN10, PN16 drilling). Mechanical Joint and other Inlet Connections available.
- Available as 2-Hole & 1 Pumper or 2-Hose only.

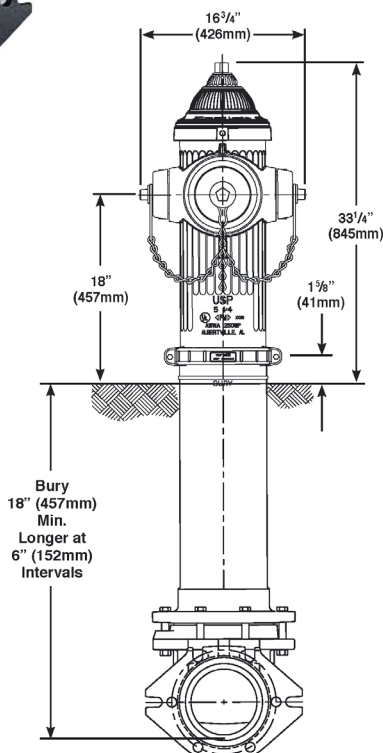

PRODUCT FEATURES

ID	PART NAME	MATERIAL
U-1	Operating Nut with Lubrication Port	Ductile Iron
U-2	Operating Nut Seal	Rubber
U-3	Operating Nut Locking Pin	Steel
U-4	Hydrant Lubricant (in chamber)	Diana 2100
U-5	Travel Stop Nut	Steel
U-6	Hold Down Nut	Bronze
U-7	Hold Down Nut Screw	Steel
U-8	Bonnet	Ductile Iron
U-9	Bonnet Locking Screw	Stainless Steel
U-10	Bonnet Seal	Rubber
U-11	Hold Down Nut O-ring	Rubber
U-12	Bonnet - Revolving Nut O-rings	Rubber
U-13	Revolving Nut	Rubber
U-14	Inner Revolving Nut O-rings	Rubber
U-15	Pumper Nozzle	Rubber
U-16	Pumper Nozzle Cap Gasket	Rubber
U-17	Pumper Nozzle Cap	Cast Iron
U-18	Pumper Nozzle O-ring	Rubber
U-19	Nozzle Lock	Stainless Steel
U-20	Hose Nozzle	Bronze
U-21	Hose Nozzle Cap Gasket	Rubber
U-22	Hose Nozzle O-ring	Rubber
U-23	Hose Nozzle Cap	Cast Iron
U-24	Valve Rod Upper	Steel
U-25	Standpipe Upper	Ductile Iron
U-26	Stem Coupling	Stainless Steel
U-27	Cotter Pin	Stainless Steel
U-28	Clevis Pins	Stainless Steel
U-29	Traffic Flange O-ring	Rubber
U-30	Traffic Standpipe Coupling Halve	Cast Iron
U-31	Standpipe Coupling Nuts & Bolts	Stainless Steel
U-32	Valve Rod Lower	Steel
U-33	Standpipe Lower	Cast Iron
U-34	Top Plate Pin - Shear Proof	Stainless Steel
U-35	Upper Valve Plate	Bronze
U-36	Drain Valve Facing	Plastic
U-37	Drain Valve Facing Screw	Stainless Steel
U-38	Bottom Seat O-ring	Rubber
U-39	Drain Ring	Bronze
U-40	Seat Ring	Bronze
U-41	Drain Ring Housing	Cast Iron
U-42	Drain Ring Housing O-ring	Rubber
U-43	Main Valve	Rubber
U-44	Lower Valve Plate	Cast Iron
U-45	Cap Chains	Steel
U-46	Chain Hooks	Steel
U-47	Upper Stem Pin	Stainless Steel
U-48	Shoe Bolt and Nut	Steel
U-50	Shoe	Ductile Iron
U-52	Top Seat O-ring	Rubber
U-56	Anti-Friction Bearing	Acetal
U-57	Sleeve	Copper
U-58	Stem O-ring	Rubber

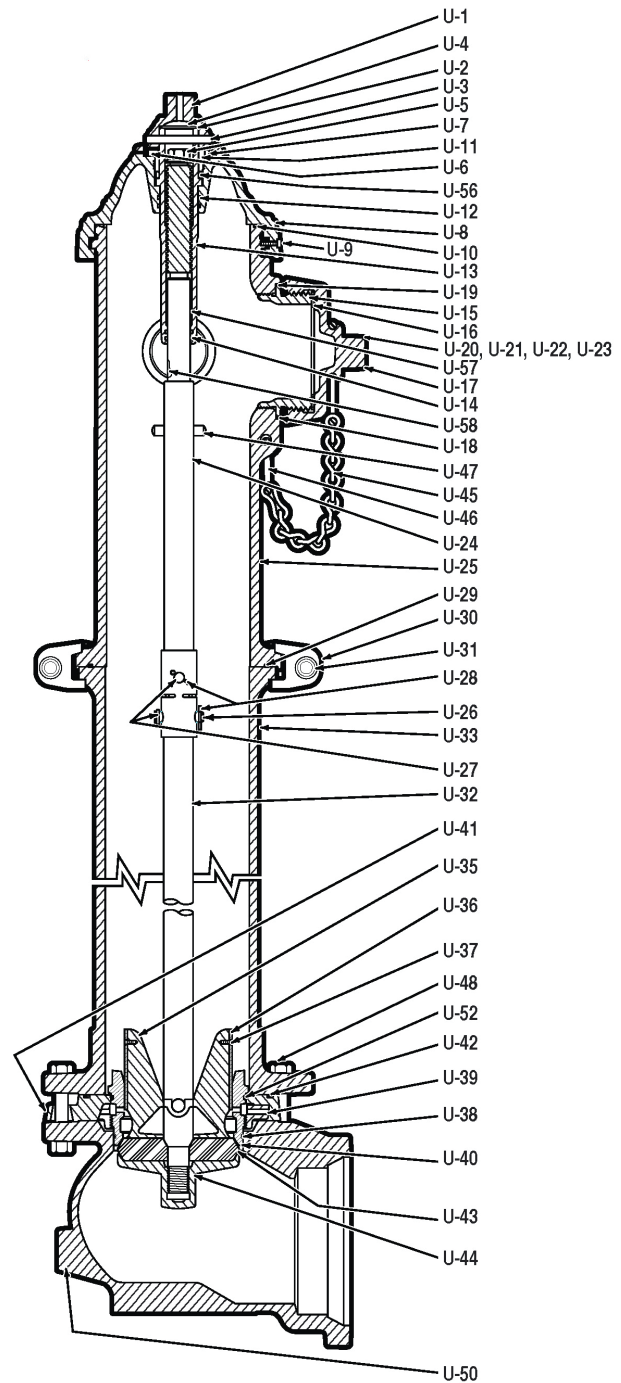

*Stainless steel fasteners available as an option.

For more information about us, or to view our full line of products, please visit www.mueller-international.com or call International Customer Service at:

UK: +44.1438.487410 Dubai: +971.4.214.6640 Singapore: +65.6816.3088 USA: +1 800.423.1323 International@muellerwp.com

Mueller refers to one or more of Mueller Water Products, Inc., a Delaware corporation ("MWP"), and its subsidiaries. MWP and each of its subsidiaries are legally separate and independent entities when providing products and services. MWP does not provide products or services to third parties. MWP and each of its subsidiaries are liable only for their own acts and omissions and not those of each other. MWP brands include Mueller®, Echologics®, Hydro Gate®, Hydro-Guard®, Jones®, Krausz®, MiNet®, Miliken®, Pratt®, Pratt Industrial®, Singer®, and U.S. Pipe Valve & Hydrant. Please see muellerwp.com/brands to learn more.

© 2020 Mueller Water Products, Inc. All Rights Reserved. The trademarks, logos and service marks displayed in this document are the property of Mueller Water Products, Inc., its affiliates or other third parties. Products above marked with a section symbol (§) are subject to patents or patent applications. For details visit www.mwppat.com.