

A - CLOSED
AA - OPEN

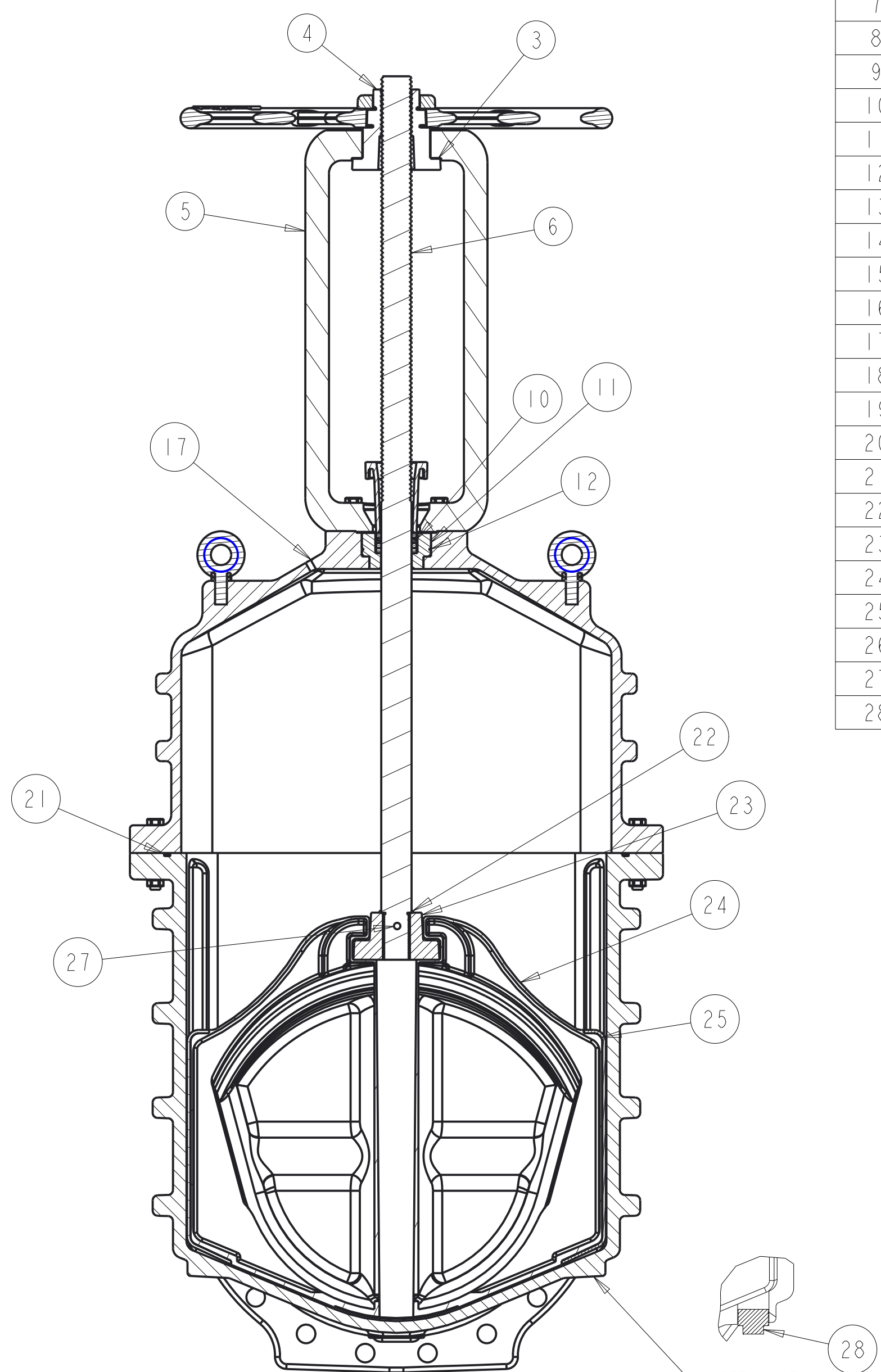

SECTION A-A

K - NO. & SIZE OF HOLES
L - DIA. OF BOLT CIRCLE
STRADDLE

PARTS LIST					
ITEM	DESCRIPTION	REQ'D	MATERIAL	ASTM	REMARKS
1	CAP NUT	1	BRONZE	B62	ALLOY C83600
2	HANDWHEEL	1	DUCTILE IRON	A536	
3	THRUST WASHER	2	BRONZE		
4	BUSH NUT	1	BRONZE	B62	ALLOY C83600
5	YOKE	1	DUCTILE IRON	A536	
6	STEM	1	BRONZE	B138	ALLOY 67600
7	GLAND FLANGE	1	DUCTILE IRON	A536	
8	GLAND BOLT	2	SEE NOTE 2		
9	GLAND NUT	2	BRONZE	B584	ALLOY C86400
10	STEM PACKING	4	LUBE FLAX		FED HH-P-106c
11	BONNET BUSHING	1	BRONZE	B62	ALLOY C83600
12	BUSHING O-RING	1	RUBBER	D2000	EPDM
13	YOKE BOLT	4	SEE NOTE 2		
14	YOKE NUT	4	SEE NOTE 2		
15	EYEBOLT	2	STEEL		GALVANIZED
16	EYEBOLT NUT	2	STEEL		GALVANIZED
17	PIPE PLUG	1	SEE NOTE 2		
18	BONNET	1	DUCTILE IRON	A536	
19	BONNET BOLT	"M"	SEE NOTE 2		
20	BONNET NUT	"M"	SEE NOTE 2		
21	BONNET O-RING	1	RUBBER	D2000	EPDM
22	STEM O-RING	1	RUBBER	D2000	EPDM
23	DISC NUT	1	BRONZE	B62	ALLOY C83600
24	DISC	1	SEE NOTE 1		
25	GUIDE CAP	2	ACETAL		
26	BODY	1	DUCTILE IRON	A536	
27	PIN	1	304 SS STEEL		
28	PIPE PLUG	2	SUPPLIED WHEN TAPPED		

NOTE:
1) RUBBER ENCAPSULATED DUCTILE IRON DISC
RUBBER - EPDM ASTM D2000
DUCTILE IRON ASTM A536 GRADE 65-45-12
2) BOLTS - 316 STAINLESS STEEL ASTM F593 GROUP 2-CW
NUTS - 316 STAINLESS STEEL ASTM F594 GROUP 2-CW

18" - 24" RWGV OS&Y

DIMENSIONS FOR RWGV OS&Y - INCHES														
VALVE SIZE	A	AA	B	C	D	E	F	G	H	K	L	M	N	TURNS TO OPEN
18	65.88	85.68	17.00	30.50	32.00	18.38	17.00	1.66	25.13	16 - 1.25	22.75	12	1.88	57
20	71.50	93.50	18.00	33.75	32.00	20.38	18.00	1.78	28.25	20 - 1.25	25.00	12	2.00	63
24	79.89	104.40	20.00	39.50	32.00	24.38	20.00	2.00	33.13	20 - 1.38	29.50	16	2.25	75

APPROVED
By Matthew Sliger at 3:27 pm, Oct 10, 2017

DR BY: AO	9/15/17	UNLESS OTHERWISE NOTED	THIRD ANGLE PROJECTION	C.D. NO.
CHKD: BB	9/15/17	BREAK CAST CORNERS!		PART. NO.
ENGR: MS	9/15/17	BREAK MACH CORNERS!		
MFR:		TOLERANCES	REF. NO.	SCALE
MFG:		UNLESS OTHERWISE NOTED	STR. NO.	NONE
TOOL:		L INEAR ±		
FBY:		ANGULAR ±		
MAT'L: NOTED		DESCR: 18" - 24" RWGV OS&Y		
		NUMBER		7447