

No.	DESCRIPTION	MATERIAL DESCRIPTION
1	BODY	CAST LOW LEAD BRASS ALLOY
2	CAP	CAST BRASS ASTM B62 ALLOY C83600
3	STEM	LOW LEAD BRASS ALLOY
4	BALL	LOW LEAD BRASS ALLOY
5	GASKET	DYNEON TFMI600 DR DUPONT PTFE TE-6473
6	SOLID PIN	AISI 304 STAINLESS STEEL
7	O-RING	ASTM D2000 (EP)
8	END PIECE	CAST LOW LEAD BRASS ALLOY
9	O-RING	ASTM D2000 (EP)
10	CTS GASKET SUB	ASTM D2000(SBR)&410 STAINLESS STEEL
11	CONN NUT	CAST BRASS ASTM B62 ALLOY C83600
12	O-RING	ASTM D2000 (EP)

SIZE	ØA	B	C	D	E
3/4"	.75	3.59	.84	2.43	3.27
1"	1.00	5.02	1.05	2.67	3.73
1-1/2"	1.50	5.06	1.66	3.37	5.03
2"	2.00	5.22	1.82	3.92	5.74

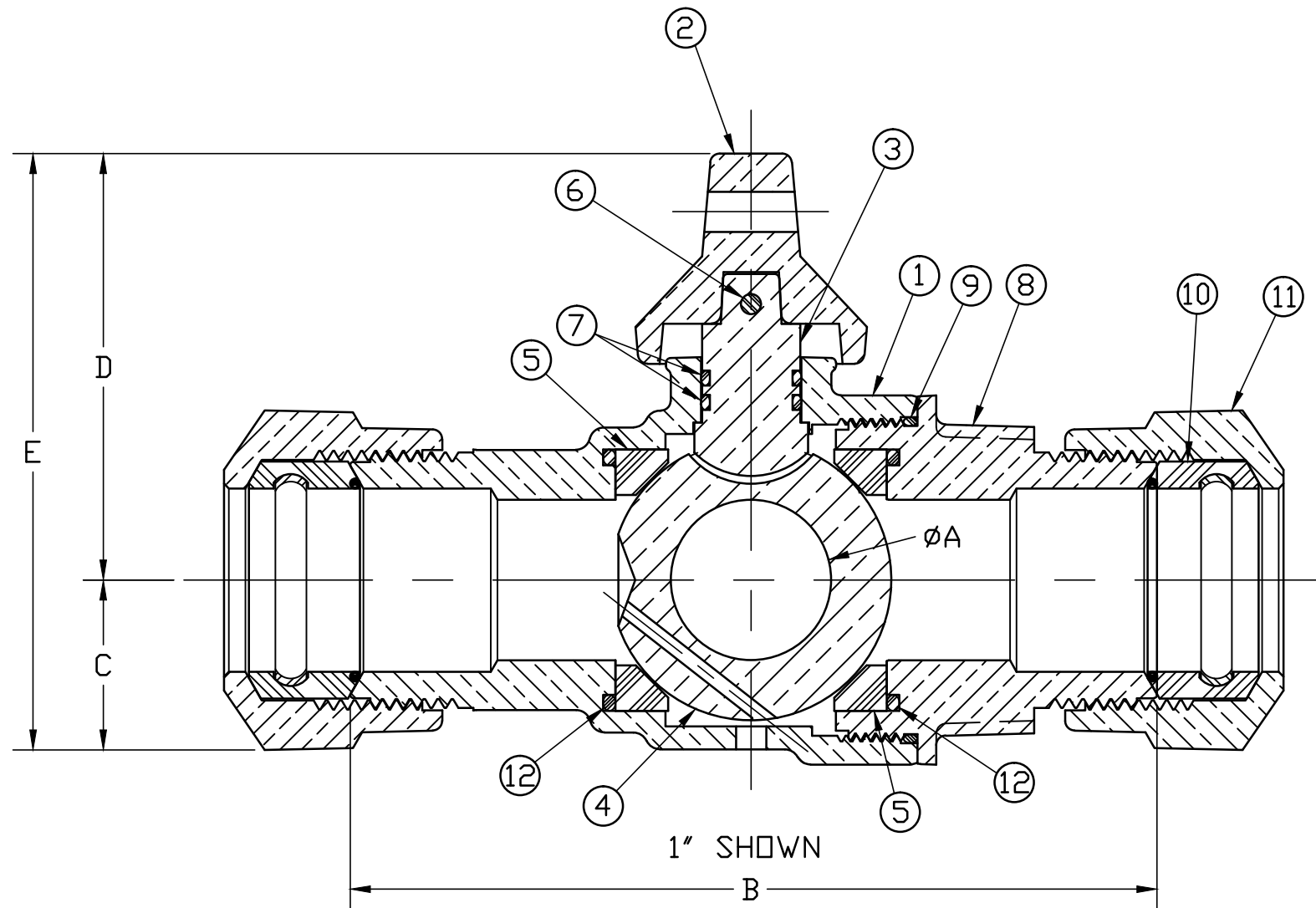

NOTE: ALL WETTED PARTS ARE LOW LEAD BRASS ALLOY

FILEPATH: PROD-ENG\MUELLER\ASYSUBMITTALS\B25219N

DRFTR	Garvin	8/2/11	Mueller Co.	
CHKR				
ENGR				
MGR				
UNLESS OTHERWISE NOTED			THIRD ANGLE PROJECTION	
SURFACE PREPARATION:				
BREAK CORNER(S) ---- .000				
SURFACE FINISH -- XX RMS			REF. No.	SCALE
TOLERANCE(S):			FULL	
LINEAR ----- ± .000				
ANGULAR ----- ± 0°00'				
BY DATE				
STK No:				
MAT'L:				
DESCR:				
PER EST NO: DXXXX EST FIN WT = 0.0000 lbs			DWG NUMBER B25219N	

DWG NUMBER
B25219N
442-MRKTG

TITLE TO AND OWNERSHIP OF THIS ENGINEERING DATA REMAINS IN Mueller Co. NO USE IS TO BE MADE OF THIS DATA EXCEPT AS SPECIFICALLY AUTHORIZED BY Mueller Co. ASSENT ON THE PART OF THE RECIPIENT TO THESE CONDITIONS IS PRESUMED