

No.	DESCRIPTION	MATERIAL
1	STEM	LOW LEAD BRASS ALLOY
2	O-RING	EPDM D2000
3	BALL	LOW LEAD BRASS ALLOY
4	GASKET - SEAL	NITRILE D2000
5	BODY	CAST LOW LEAD BRASS ALLOY
6	CAP	CAST BRASS ASTM B62 ALLOY C83600
7	SEALING PLUG	CAST LOW LEAD BRASS ALLOY
8	ROLLPIN	STAINLESS STEEL ASTM A240 TYPE 302
9	O-RING	EPDM D2000
10	PJ GASKET	BUNA-N ASTM D2000
11	PJ WASHER	POLYPROPYLENE
12	COMPRESSION RING	BRASS ASTM B505 ALLOY C83600
13	COMPRESSION NUT	CAST BRASS ASTM B62 ALLOY C83600

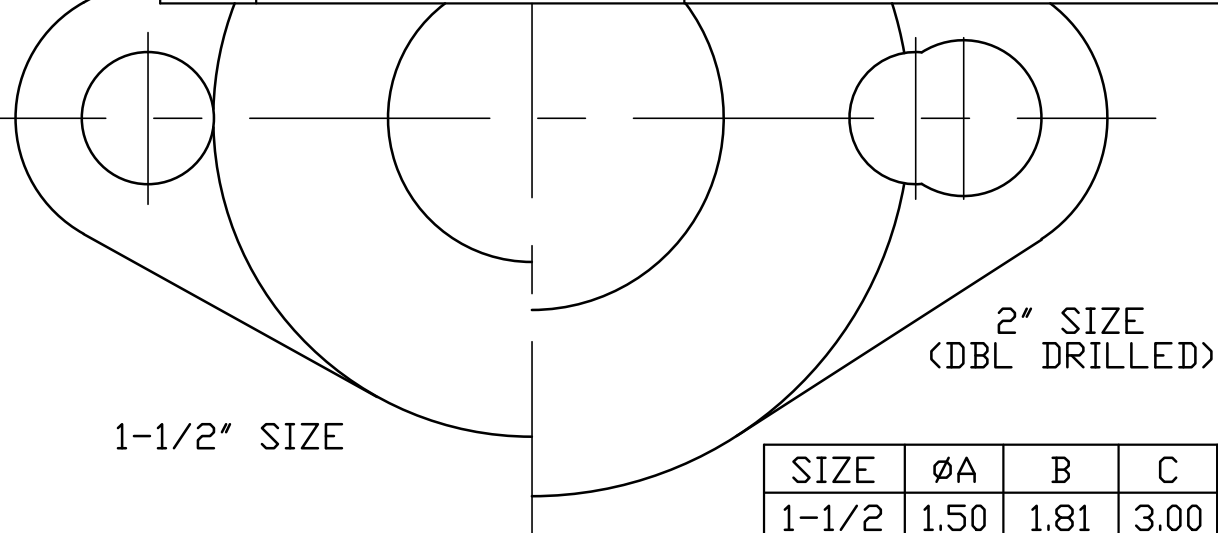

SIZE	ØA	B	C	D	E
1-1/2	1.50	1.81	3.00	3.53	6.53
2	2.00	2.19	3.78	4.22	8.00

ALL WETTED PARTS ARE LOW LEAD BRASS ALLOY

FILEPATH: PROD-ENG\MUELLER\ASYSUBMITTALS\G24276N

DRFTR	RWB	3/25/13	Mueller Co.		
CHKR					
ENGR					
MGR					
UNLESS OTHERWISE NOTED			THIRD ANGLE PROJECTION		
SURFACE PREPARATION:			REF. No. SCALE		
BREAK CORNER(S) ---- .000					
SURFACE FINISH -- XX RMS			NONE		
TOLERANCE(S):					
LINEAR ----- ± .000					
ANGULAR ----- ± 0°00'					
STK No:					
MAT'L:					
DESCR.			DWG NUMBER		
ANGLE METER BALL LLB VALVE			G24276N		
(GRIP x METER)					
REV	ECR	DESCRIPTION	DATE	BY	CHKR
PER EST NO: DXXXX EST FIN WT = 0.0000 lbs					

DWG NUMBER
G24276N
442-MRKTG