

No.	DESCRIPTION	MATERIAL
1	BODY	CAST LOW LEAD BRASS ALLOY
2	KEY	CAST LOW LEAD BRASS ALLOY
3	KEY WASHER	CAST BRONZE ASTM B62 ALLOY C83600
4	KEY NUT	CAST BRONZE ASTM B62 ALLOY C83600

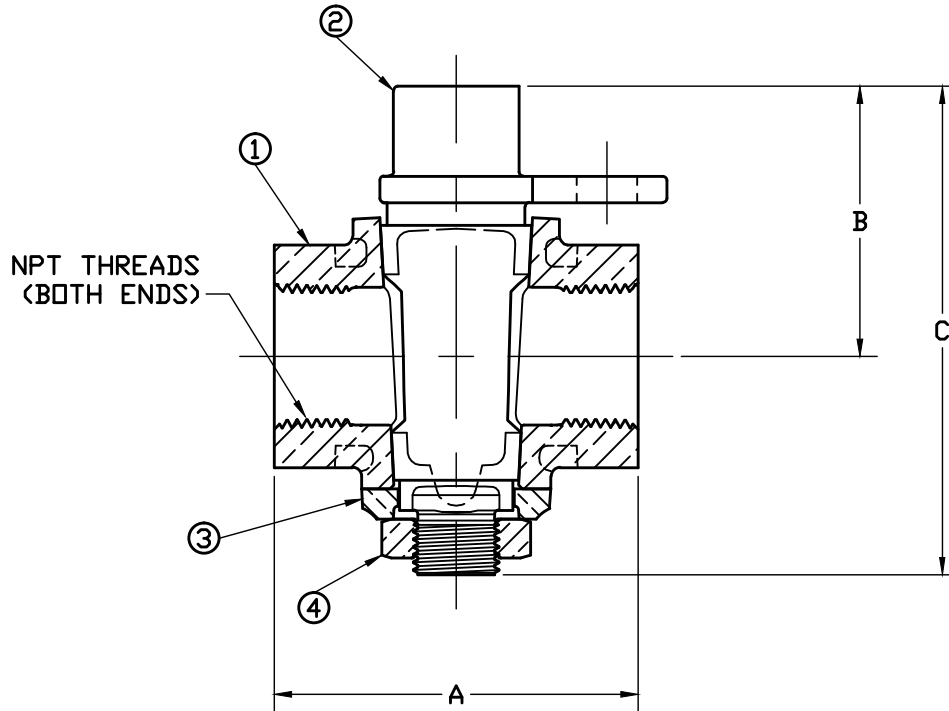

SIZE	A	B	C	NPT SIZE
3/4	2.64	1.96	3.54	3/4"
1	3.25	2.15	3.96	1"

**NOTE: ALL WETTED PARTS ARE LOW LEAD BRASS ALLOY**

FILEPATH: PROD-ENG\MUELLER\ASYSUBMITTALS\H10262N

DRFTR	JGarvin	11/4/09	<b>Mueller Co.</b>		
CHKR					
ENGR					
MGR					
			UNLESS OTHERWISE NOTED	THIRD ANGLE PROJECTION	
			SURFACE PREPARATION:		
			BREAK CORNER(S) ---- .000		
			SURFACE FINISH -- 000 RMS	REF. No.	
			TOLERANCE(S):	SCALE	
			LINEAR ----- ± .000	FULL	
			ANGULAR ----- ± 0°00'		
			BY	DATE	
			STK No:		
			MAT'L:		
REV	ECR	DESCRIPTION	DATE	BY	CHKR
DESCR. GROUND KEY VALVE LOW LEAD BRASS(FIP x FIP)					
PER EST NO: DXXXX EST FIN WT = 0.0000 lbs					PART NUMBER H10262N

PART NUMBER  
H10262N  
442-MRKTG