

No.	DESCRIPTION	MATERIAL	ASTM	ALLOY OR TYPE
1	BODY	BRASS		CAST LOW LEAD ALLOY
2	O-RING	RUBBER	D-2000	EP
3	STEM	BRASS		LOW LEAD ALLOY
4	BALL	BRASS		LOW LEAD ALLOY
5	GASKET	RUBBER	D-2000	NITRILE
6	O-RING	RUBBER	D-2000	EP
7	END PIECE	BRASS		CAST LOW LEAD ALLOY
8	O-RING	RUBBER	D-2000	NITRILE
9	INS. TAILPC ASS'Y	BRASS w/ NYLON		CAST LOW LEAD ALLOY
10	COUP. NUT	BRASS	B-62	ALLOY C83600
11	TUBE NUT	BRASS	B-62	ALLOY C83600

SIZE	ØA	B	C	D	E
3/4"	.750	1.391	1.150	2.540	5.905
1"	1.000	1.564	1.375	2.939	6.614

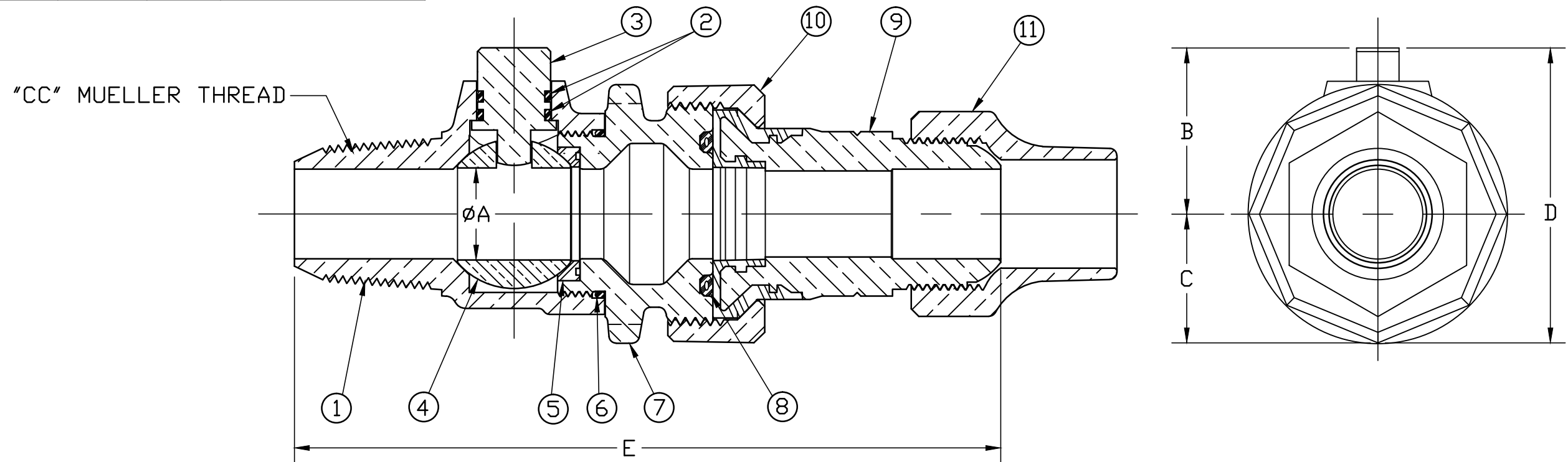

NOTE: ALL WETTED PARTS ARE LOW LEAD BRASS ALLOY

FILEPATH: PROD-ENG\MUELLER\ASYSUBMITTALS\N35000N

DRFTR	RWB	7/11/13	Mueller Co.		
CHKR					
ENGR					
MGR					
			UNLESS OTHERWISE NOTED	THIRD ANGLE PROJECTION	
			SURFACE PREPARATION:		
			BREAK CORNER(S) ---- .000		
			SURFACE FINISH -- 000 RMS	REF. No.	
			TOLERANCE(S):	SCALE	
			LINEAR ----- ± .000	NONE	
			ANGULAR ----- ± 0°00'		
			STK No:		
			MAT'L:		
			DESCR.		
			BALL CORP VALVE LLB ASS'Y	DWG NUMBER	
			CC x CS INSULATED UNION	N35000N	
REV	ECR	DESCRIPTION	DATE	BY	CHKR
PER EST NO: XXXXX EST FIN WT = 0.0000 lbs					

DWG NUMBER
N35000N
44-MRKTNG

TITLE TO AND OWNERSHIP OF THIS ENGINEERING DATA REMAINS IN Mueller Co. NO USE IS TO BE MADE OF THIS DATA EXCEPT AS SPECIFICALLY AUTHORIZED BY Mueller Co. ASSENT ON THE PART OF THE RECIPIENT TO THESE CONDITIONS IS PRESUMED.