

ITEM	REQ'D	DESCRIPTION	MATERIAL	ASTM	ALLOY OR TYPE
1	1	BODY	BRASS	B584	ALLOY C89520
2	1	CAP	BRASS	B62	ALLOY C83600
3	1	STEM	BRASS	B584	ALLOY C89520
4	1	BALL	BRASS	B584	ALLOY C89520
5	2	GASKET	RUBBER	D-2000	NITRILE (BUNA-N)
6	1	SPIRODL PIN	ST. STEEL	A-240	TYPE 304
7	2	O-RING	RUBBER	D-2000	CODE R-80
8	1	END PIECE	BRASS	B584	ALLOY C89520
9	1	SADDLE NUT	BRASS	B62	ALLOY C83600
10	1	SNAP RING	COPPER		ALLOY CDA521
11	1	RUBBER GASKET	RUBBER	D-2000	CODE R-9
12	1	CAP PLUG	PLASTIC	PLASTIC	RED POLYETHYLENE

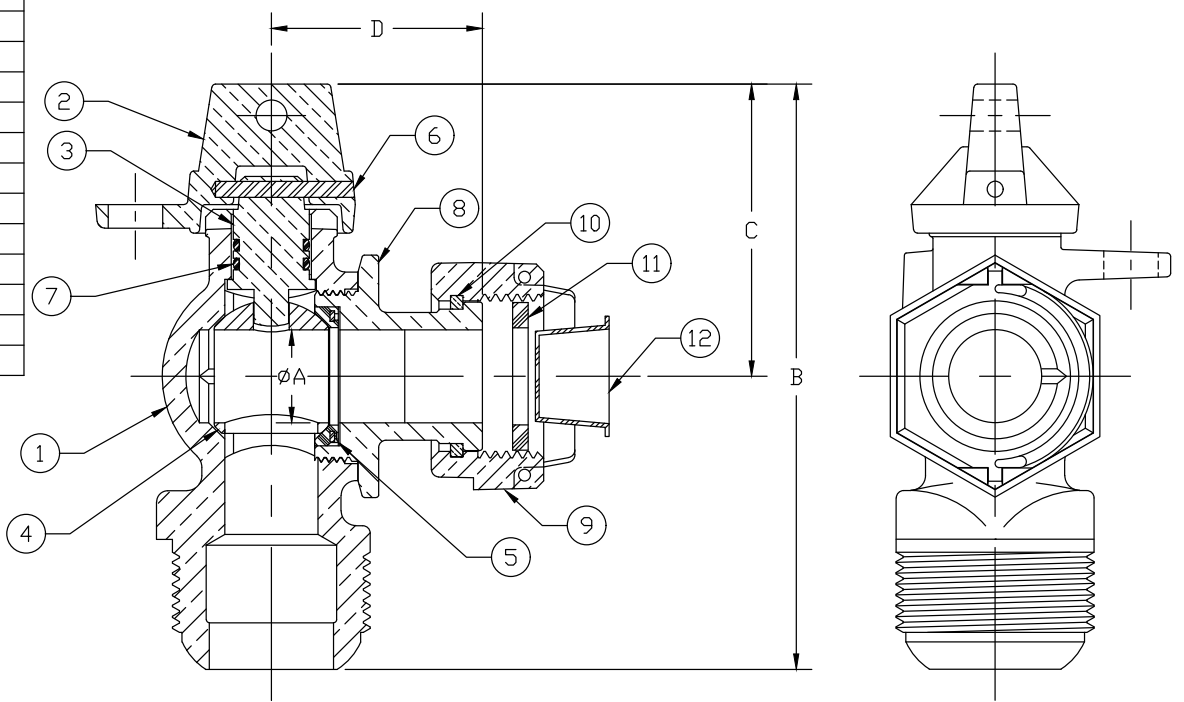

SIZE	ØA	B	C	D
5/8" x 3/4" x 3/4"	.75	4.33	2.35	1.69
5/8" x 3/4" x 1"	.75	4.71	2.35	1.69
1"	1.00	5.00	2.64	1.95

ALL WETTED PARTS ARE NO LEAD BRASS ALLOY  
 FILEPATH: PROD-ENG\MUELLER\APPROVED\B2425517N

DWG NUMBER  
B2425517N

TITLE TO AND OWNERSHIP OF THIS ENGINEERING DATA REMAINS IN Mueller Co. NO USE IS TO BE MADE OF THIS DATA EXCEPT AS SPECIFICALLY AUTHORIZED BY Mueller Co. ASSENT ON THE PART OF THE RECIPIENT TO THESE CONDITIONS IS PRESUMED

DRF TR	RWB	7/17/20	<b>MUELLER</b>	UNLESS OTHERWISE NOTED SURFACE PREPARATION: BREAK CORNER(S) ---- .000 SURFACE FINISH -- .000 RMS TOLERANCE(S): LINEAR ----- ± .000 ANGULAR ----- ± 0°00'	THIRD ANGLE PROJECTION		
CHKR					REF. No.	SCALE	
ENGR						NONE	
MGR							
BY DATE			STK No:				
ADD REDUCE PORT 10/16/13 RWB			MAT'L:				
REV	ECR	DESCRIPTION	DATE	BY	CHKR	DESCR.	DWG NUMBER
						CS X MTR SWIVEL LESS TUBE NUT NLB ANGLE METER VALVE	B2425517N
PER EST NO: DXXXX EST FIN WT = 0.0000 lbs							