

VALVE SIZE	A	B	C	D
1-1/2"	1.50	4.23	3.36	1.50
2"	2.00	5.64	3.91	1.82

No.	DESCRIPTION	MATERIAL DESCRIPTION
1	BODY	CAST LOW LEAD BRASS ALLOY
2	CAP	CAST BRASS ASTM B62 ALLOY C83600
3	STEM	LOW LEAD BRASS ALLOY
4	BALL	LOW LEAD BRASS ALLOY
5	GASKET	NITRILE ASTM D2000
6	SOLID PIN	AISI 304 ANNEALED STAINLESS STEEL
7	O-RING	EP ASTM D2000
8	END PIECE	CAST LOW LEAD BRASS ALLOY
9	O-RING	EP ASTM D2000
10	CTS GSKT SUB	SBR ASTM D2000 -GSKT 410ss -BAND
11	CONNX NUT	CAST BRASS ASTM B62 ALLOY C83600

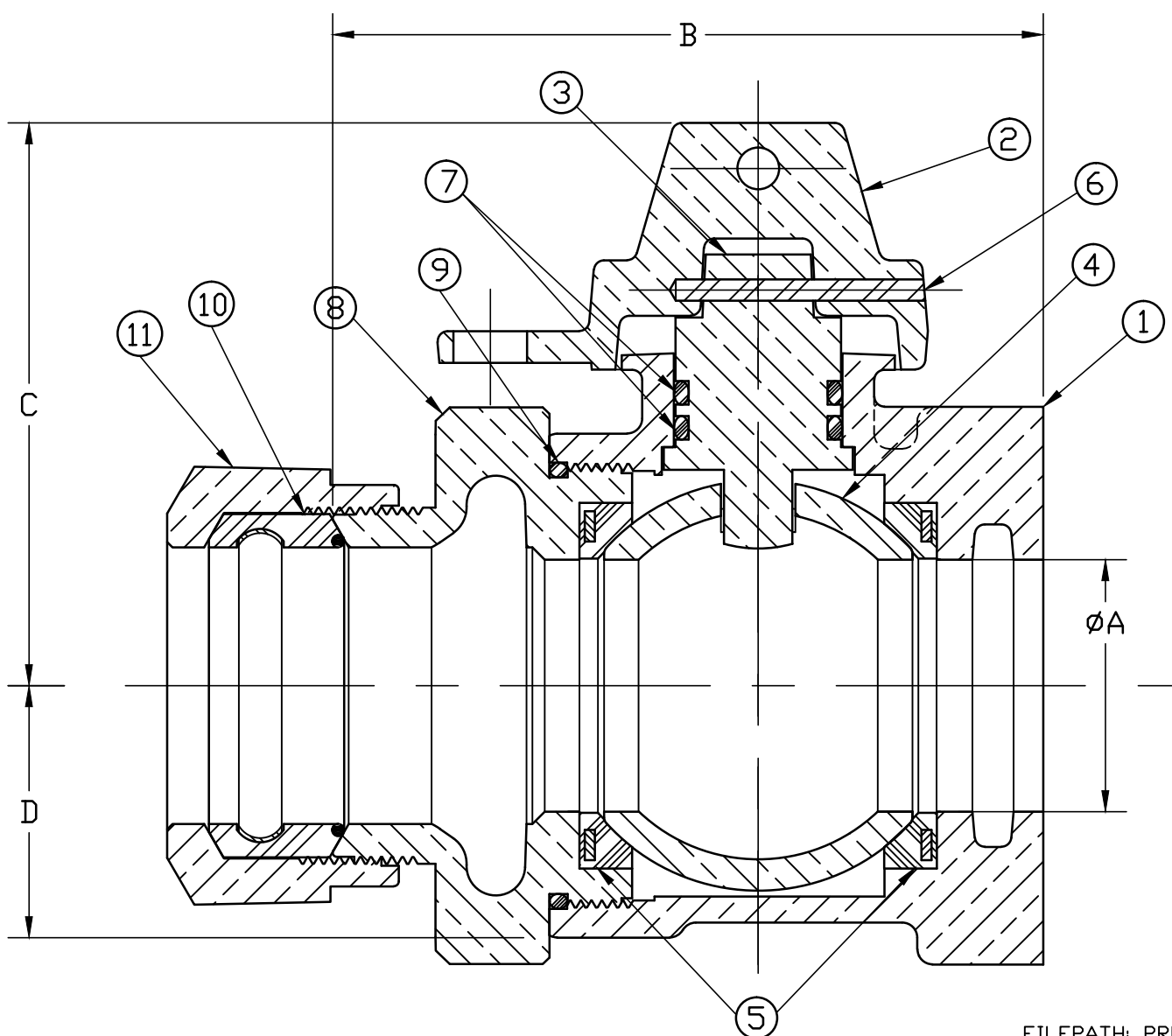

ALL WETTED PARTS ARE LOW LEAD BRASS ALLOY

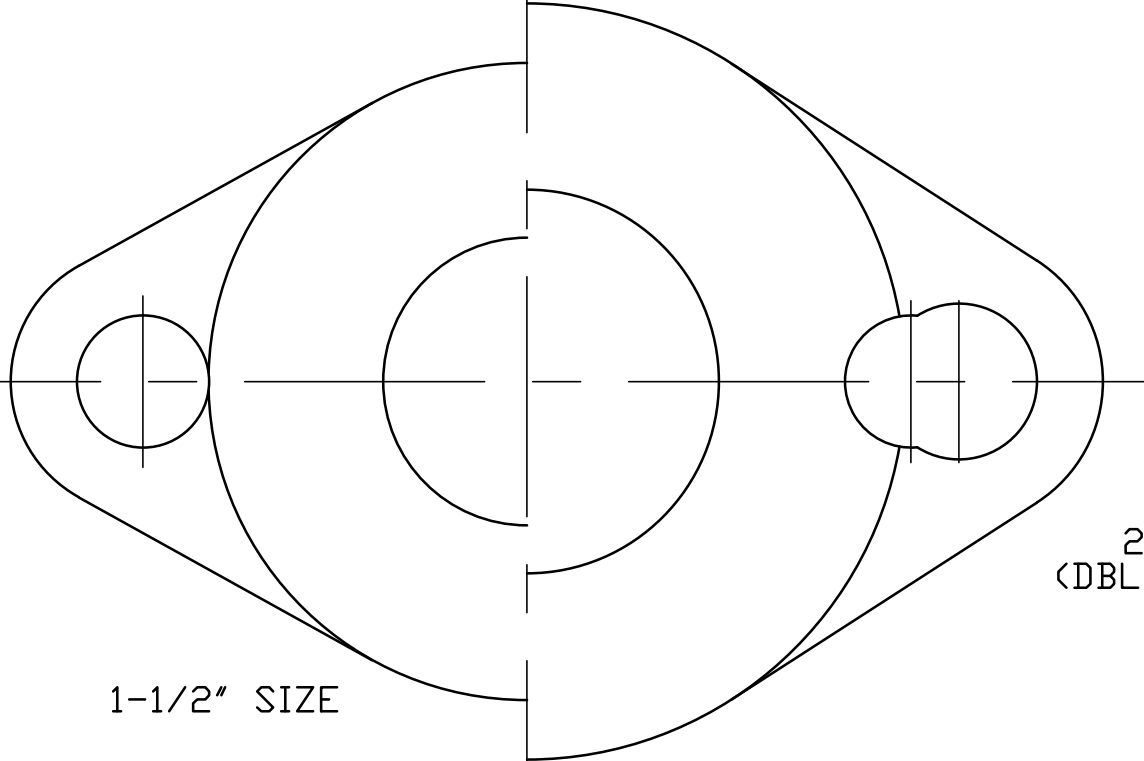

2" SIZE
(DBL DRILLED)

FILEPATH: PRODD-ENG\MUELLER\ASYSUBMITTALS\B24355N

DRFTR	JGarvin	4/6/11	Mueller Co.		
CHKR					
ENGR					
MGR					
UNLESS OTHERWISE NOTED			THIRD ANGLE PROJECTION		
SURFACE PREPARATION:			REF. No. SCALE		
BREAK CORNER(S) ---- .000					
SURFACE FINISH -- XX RMS					
TOLERANCE(S):					
LINEAR ----- ± .000					
ANGULAR ----- ± 0°00'					
BY DATE					
STK No:					
MAT'L:					
DESCR.			DWG NUMBER		
LLB INLINE BALL METER VALVE			B24335N		
(110 CTS × MTR FLG)					
REV	ECR	DESCRIPTION	DATE	BY	CHKR
PER EST NO: DXXXX					

DWG NUMBER
B24335N
44-MRKTNG

TITLE TO AND OWNERSHIP OF THIS ENGINEERING DATA REMAINS IN Mueller Co. NO USE IS TO BE MADE OF THIS DATA EXCEPT AS SPECIFICALLY AUTHORIZED BY Mueller Co. ASSENT ON THE PART OF THE RECIPIENT TO THESE CONDITIONS IS PRESUMED.