

ITEM	DESCRIPTION	NO. REQ'D	MATERIAL	ASTM	CURRENT MATERIAL ① DESCRIPTION	ALTERNATE STANDARD ②
1	COVER	1	CAST IRON	A-126	CLASS B	
2	LIFT HANDLE	1	STEEL	A-575	GRADE M1020	
3	NUT	2	STEEL	J995	CR. 8 GALVANIZED	
4	FLUSH BOX	1	CAST IRON	A-126	CLASS B	
5	PUMPER CAP	1	CAST IRON	A-126	CLASS B	
6	PUMPER GASKET	1	RUBBER	D2000	NEOPRENE	
7	PUMPER NOZZLE	1	BRONZE	B584	ALLOY C89833	B584 C87850 DR C87600
8	HOSE CAP	2	CAST IRON	A-126	CLASS B	
9	HOSE GASKET	2	RUBBER	D2000	NEOPRENE	
10	HOSE NOZZLE	2	BRONZE	B584	ALLOY C89833	B584 C87850 DR C87600
11	OIL SCREW	1	BRASS	B-36	ALLOY 8	
12	OPERATING NUT	1	BRONZE	B584	ALLOY C89833	B584 C87850 DR C87600
13	OIL SCREW	1	BRASS	B-36	ALLOY 8	
14	HOLD DOWN NUT	1	BRONZE	B-62	ALLOY C83600	B584 C87850 DR C87600
15	UPPER BARREL	1	CAST IRON	A-126	CLASS B	
16	O' RING SEAL	1	RUBBER	D2000	2 BG 715	
17	O' RING SEAL	1	RUBBER	D2000	2 BG 715	
18	CAP SCREW	8	STEEL		ASA B18.6.2 PLATED	
19	BARREL GASKET	2	RUBBER		CLOTH INSERTED	
20	LOWER BARREL	1	DUCTILE IRON	A-536	GR. 65-45-12	GR. 70-50-05
21	STEM	1	CARBON STEEL	A-576	GR. 1144T	
22	UPPER VALVE PLATE	1	BRONZE	B584	ALLOY C89833	B584 C87850 DR C87600
23	DRAIN VALVE FACING	2	H.D. POLYETHYLENE		LS 5660-00	
24	DRAIN VALVE SCREW	4	STAINLESS STEEL	A-276	300 SERIES	
25	SEAT RING	1	BRASS	B584	ALLOY C89833	B584 C87850 DR C87600
26	SHOE BOLT	6	STEEL	SAE J429	GR. 5 GALVANIZED	
27	SHOE NUTS	6	STEEL	J995	GR. 5 GALVANIZED	
28	STEM PIN	1	STAINLESS STEEL	A276	300 SERIES	
29	MAIN VALVE	1	RUBBER	D2000	NATURAL	
30	LOWER VALVE PLATE	1	CAST IRON	A-126	CLASS B	
31	VALVE NUT	1	CAST IRON	A-126	CLASS B	
32	VALVE NUT SEAL	1	RUBBER		NATURAL	
33	LOCK WASHER	1	STAINLESS STEEL	A-126	304	
34	DRAIN RING	1	BRONZE	B-62	ALLOY C83600	B584 C87850 DR C87600
35	DRAIN RING HOUSING	1	CAST IRON	A-126	CLASS B	
36	SHOE 6" MJ	1	DUCTILE IRON	A-536	GR. 65-45-12	GR. 70-50-05
37	PUMPER NOZZLE O'RING	1	RUBBER	D2000	BUNA N	
38	HOSE NOZZLE O'RING	2	RUBBER	D2000	BUNA N	
39	NOZZLE LOCK	3	STAINLESS STEEL	A-126	305 DR 410	
40	TOP SEAL O'RING	1	RUBBER	D2000	BUNA N	
41	BOTTOM SEAL O'RING	1	RUBBER	D2000	BUNA N	
42	O' RING SEAL	1	RUBBER	D2000	BUNA N	

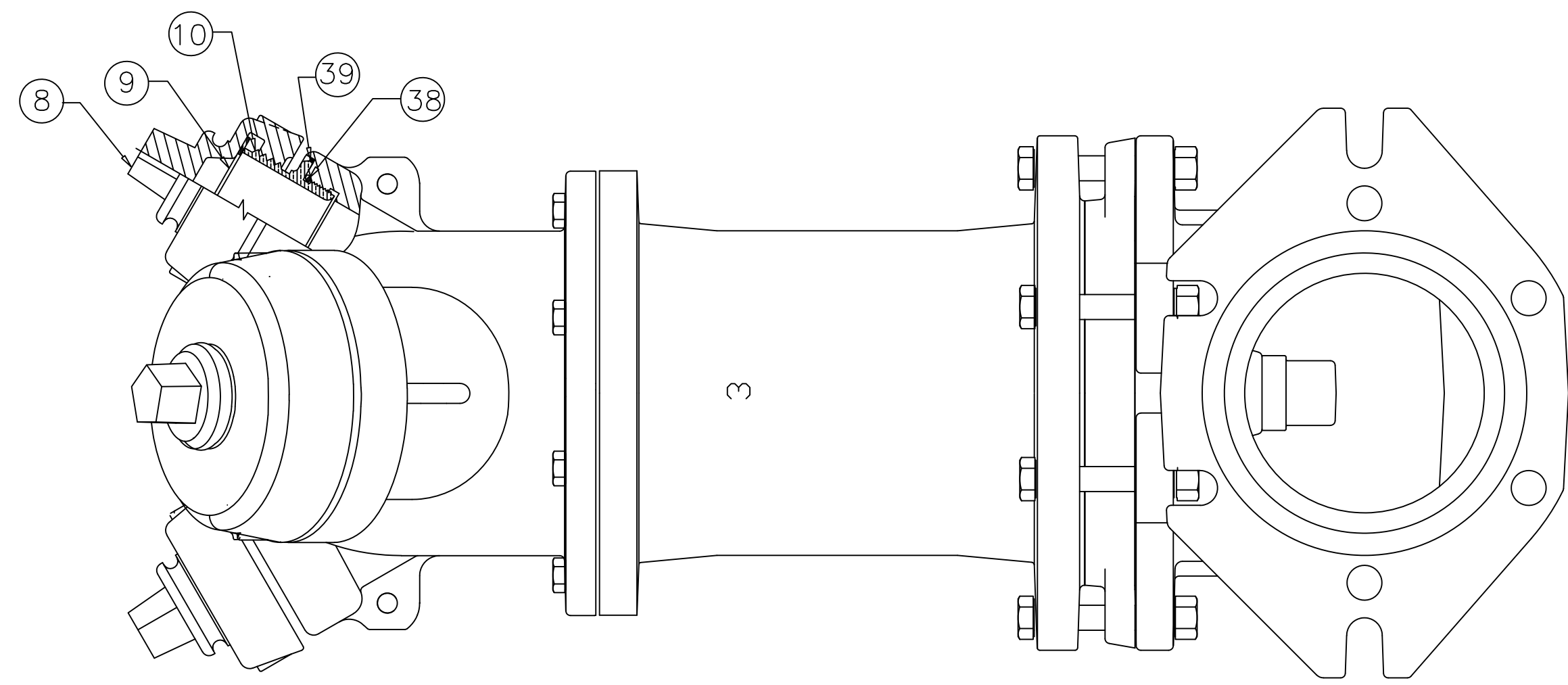
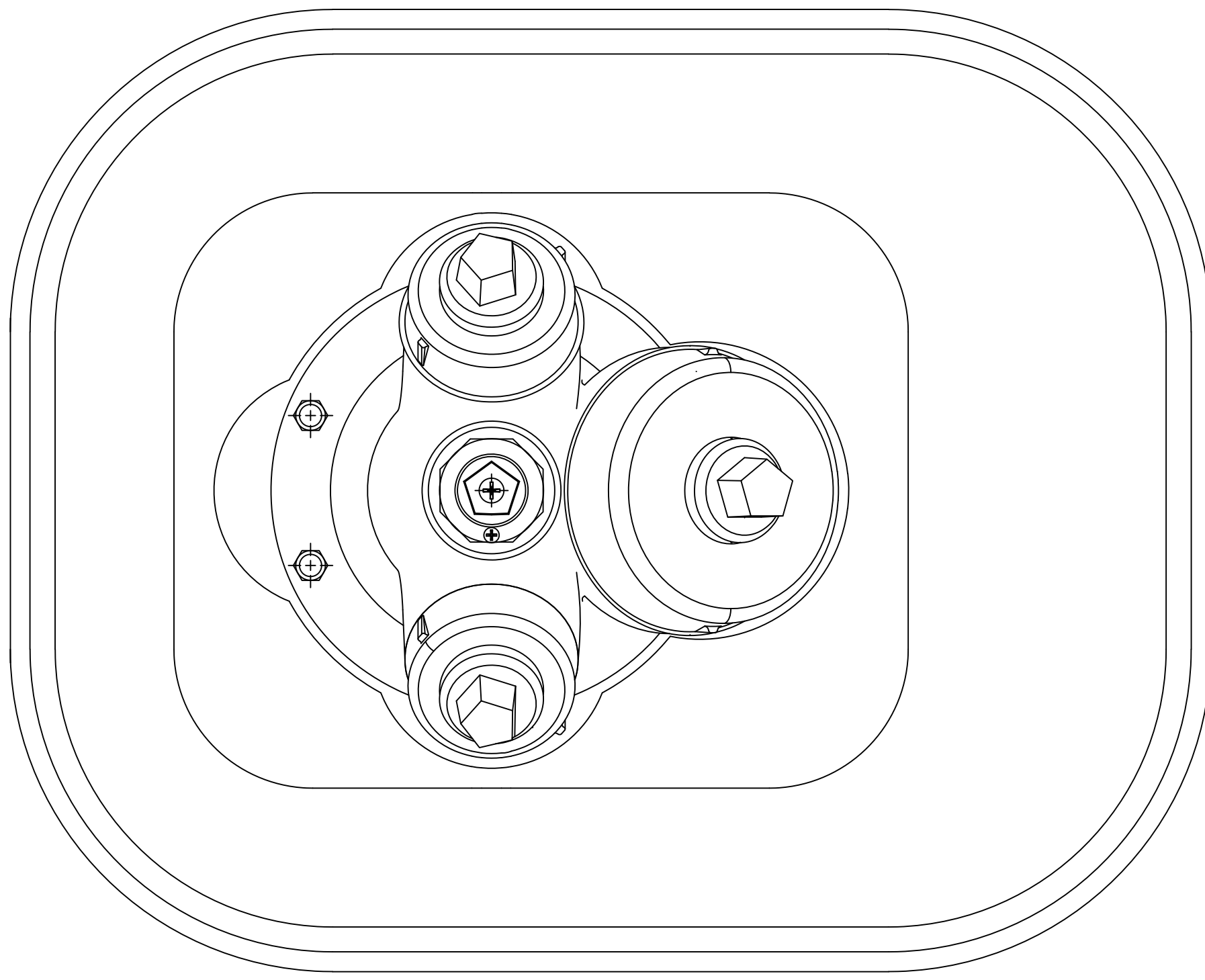

FH-92

REV.	DESCRIPTION	REF.	DRFT'R	CHK'R	APP.	DATE
D	REVISED PARTS LIST TO INCLUDE ALTERNATE STANDARD AND ADD CURRENT MATERIAL DESCRIPTION, UPDATE MAIN VALVE & UPPER VALVE PLATE, REVISE ITEM'S #14, 21, 26, & 34	E05200	MRG			2-8-23
C	REVISED ITEMS 7, 10, 12, 22, 25, & 31		JMG			11-7-13
B	CHANGE 3'-0" BURY DIMENSION TO STANDARD BURY NOTE.		ANC			5-27-10
A	REMOVE CHAINS, CHAINS ARE OPTIONAL					

A.S. (MILLIMETER) INCH INITIAL RELEASE DRFT'R JEH 5-5-98 CHK'R APP JMG 5-5-98 E.O. NUMBER EO-1547	TOLERANCES - MACHINING UNLESS OTHERWISE NOTED BREAK EDGES MACH. .006/.016 FINISH SURFACES 125 FRACTIONS ±1/64 DECIMALS 2 PL ±.025 3 PL ±	THIRD ANGLE PROJECTION PURCH. FINISH REF. NO. SCALE NONE STK. NO.
MUELLER MAT'L. DESCR. 5-1/4 FLUSH HYD. 2006 STYLE WITH CENT. SHOE		REVISION D NUMBER FH-92 SHEET 1 OF 1