

No.	DESCRIPTION	MATERIAL DESCRIPTION
1	BODY	CAST LOW LEAD BRASS ALLOY
2	KEY	CAST LOW LEAD BRASS ALLOY
3	KEY WASHER	CAST BRASS ASTM B62 ALLOY C83600
4	KEY NUT	CAST BRASS ASTM B62 ALLOY C83600

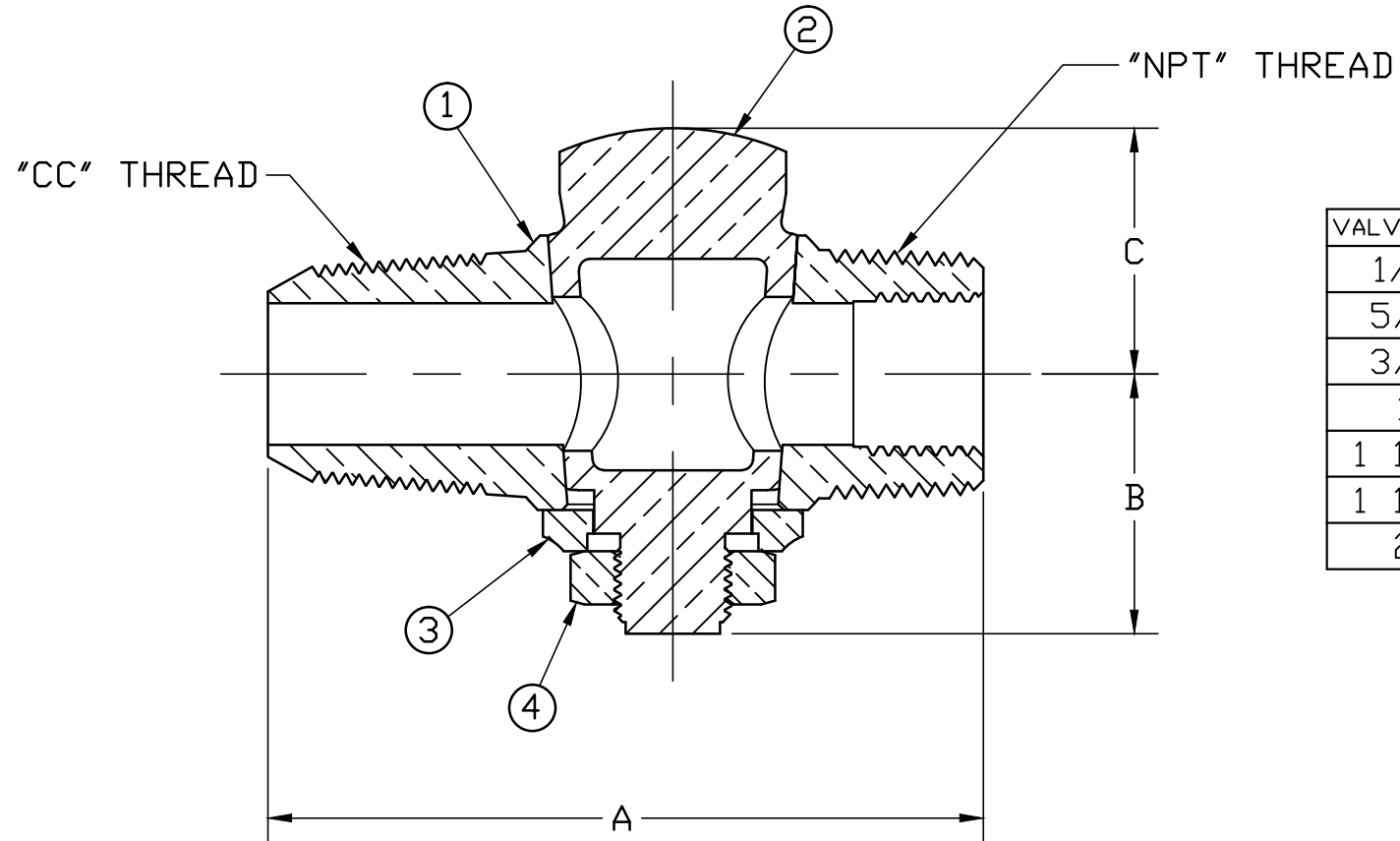

VALVE SIZE	DIM "A"	DIM "B"	DIM "C"
1/2"	3.22	1.16	1.16
5/8"	3.42	1.30	1.20
3/4"	3.79	1.38	1.30
1"	4.39	1.46	1.41
1 1/4"	5.25	2.00	1.80
1 1/2"	6.03	2.33	2.16
2"	7.13	2.47	2.36

ALL WETTED PARTS ARE LOW LEAD BRASS ALLOY

FILEPATH: PROD-ENG\MUELLER\ASYSUBMITTALS\H10003N

DRFTR	JGarvin	1/24/12	Mueller Co.		
CHKR					
ENGR					
MGR					
			UNLESS OTHERWISE NOTED		
			THIRD ANGLE PROJECTION		
			SURFACE PREPARATION:		
			BREAK CORNER(S) ---- .000		
			SURFACE FINISH -- XX RMS		
			TOLERANCE(S):		
			LINEAR ----- ± .000		
			ANGULAR ----- ± 0°00'		
			REF. No.		
			SCALE		
			FULL		
STK No:					
MAT'L:					
DESCR.					
CORPORATION STOP VALVE - LLB			DWG NUMBER		
("CC" x "MIP" w/ SCREW PLUG THRD)			H10003N		
REV	ECR	DESCRIPTION	DATE	BY	CHKR
PER EST NO: DXXXX EST FIN WT = 0.0000 lbs					

DWG NUMBER
H10003N
44² - MRKTG

TITLE TO AND OWNERSHIP OF THIS ENGINEERING DATA REMAINS IN Mueller Co. NO USE IS TO BE MADE OF THIS DATA EXCEPT AS SPECIFICALLY AUTHORIZED BY Mueller Co. ASSENT ON THE PART OF THE RECIPIENT TO THESE CONDITIONS IS PRESUMED.