

No.	DESCRIPTION	MATERIAL
1	COPPER GASKET	COPPER ASTM B152 ALLOY C11000
2	COUPLING NUT	CAST BRASS ALLOY ASTM B584
3	SNAP RING	COPPER ALLOY CDA 521
4	TAILPIECE	LEAD FREE BRASS ALLOY ASTM B584
5	CONN. NUT	CAST BRASS ALLOY ASTM B584
6	CTS GSKT SUB	SBR D2000 - GSKT 410ss - BAND

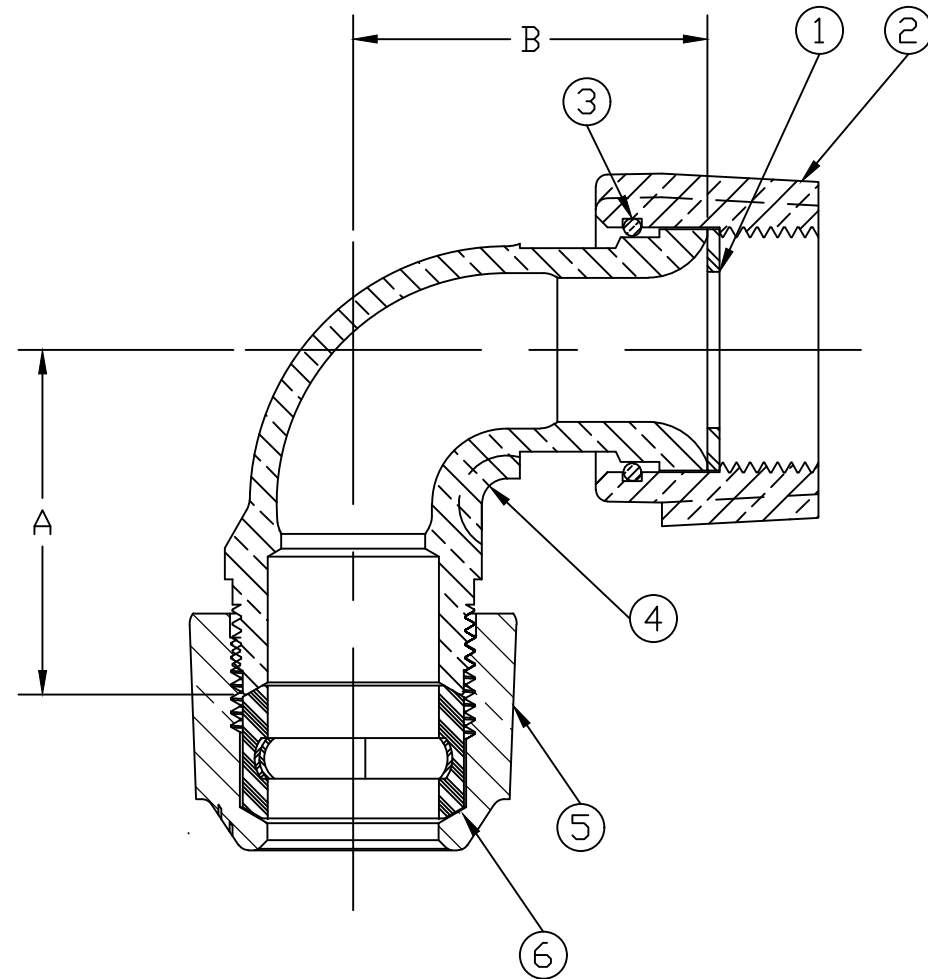

SIZE	A	B
3/4"	1.796	1.832
1"	2.000	2.060
1" x 3/4"	2.000	2.000
1-1/2"	3.344	2.094
2"	3.625	2.641

MEETS ALL REQUIREMENTS OF AWWA C800
 ALL WETTED PARTS ARE LEAD FREE BRASS ALLOY C89833/C87850
 ALL NON WETTED PARTS ARE BRASS ALLOY C83600/C87850

DWG NUMBER
H15076N

TITLE TO AND OWNERSHIP OF THIS ENGINEERING
 DATA REMAINS IN Mueller Co. NO USE IS TO BE
 MADE OF THIS DATA EXCEPT AS SPECIFICALLY
 AUTHORIZED BY Mueller Co. ASSENT ON THE PART
 OF THE RECIPIENT TO THESE CONDITIONS IS PRESUMED

DRFTR	AD	02/20/23	MUELLER	
CHKR				
ENGR			UNLESS OTHERWISE NOTED	THIRD ANGLE PROJECTION
MGR				SURFACE PREPARATION: BREAK CORNER(S) ----- .000 SURFACE FINISH -- XX RMS TOLERANCE(S): LINEAR ----- ± .016 ANGULAR ----- ± 0°00'
STK No:	BY	DATE		
MAT'L:				
DESCR.	1/4 BEND CORP STOP COUPLING (SWIVEL FCS x 110CTS)			DWG NUMBER H15076N