

SECTION A-A - TYPICAL

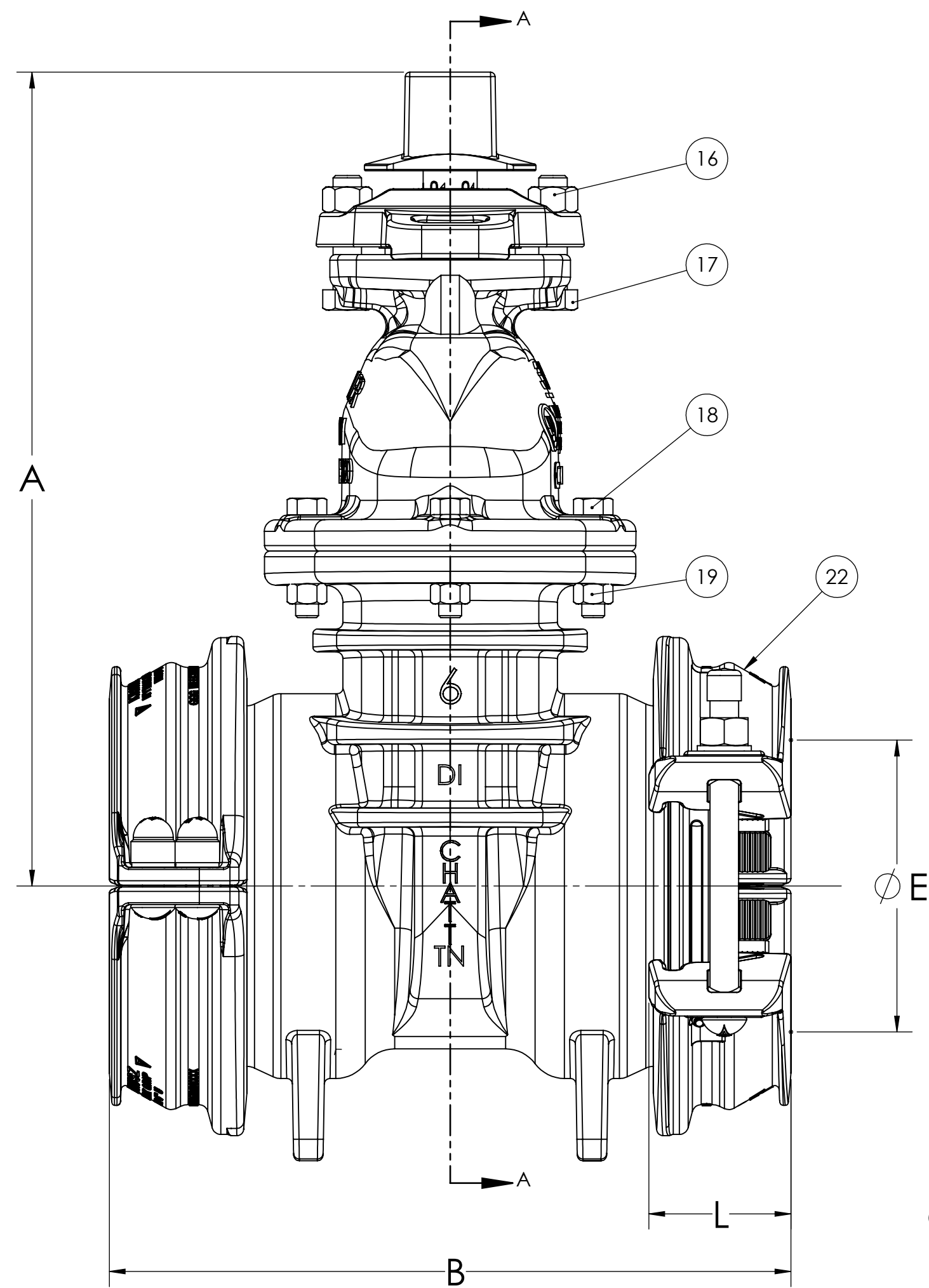

HYMAX JOINT ENDS - HM x HM

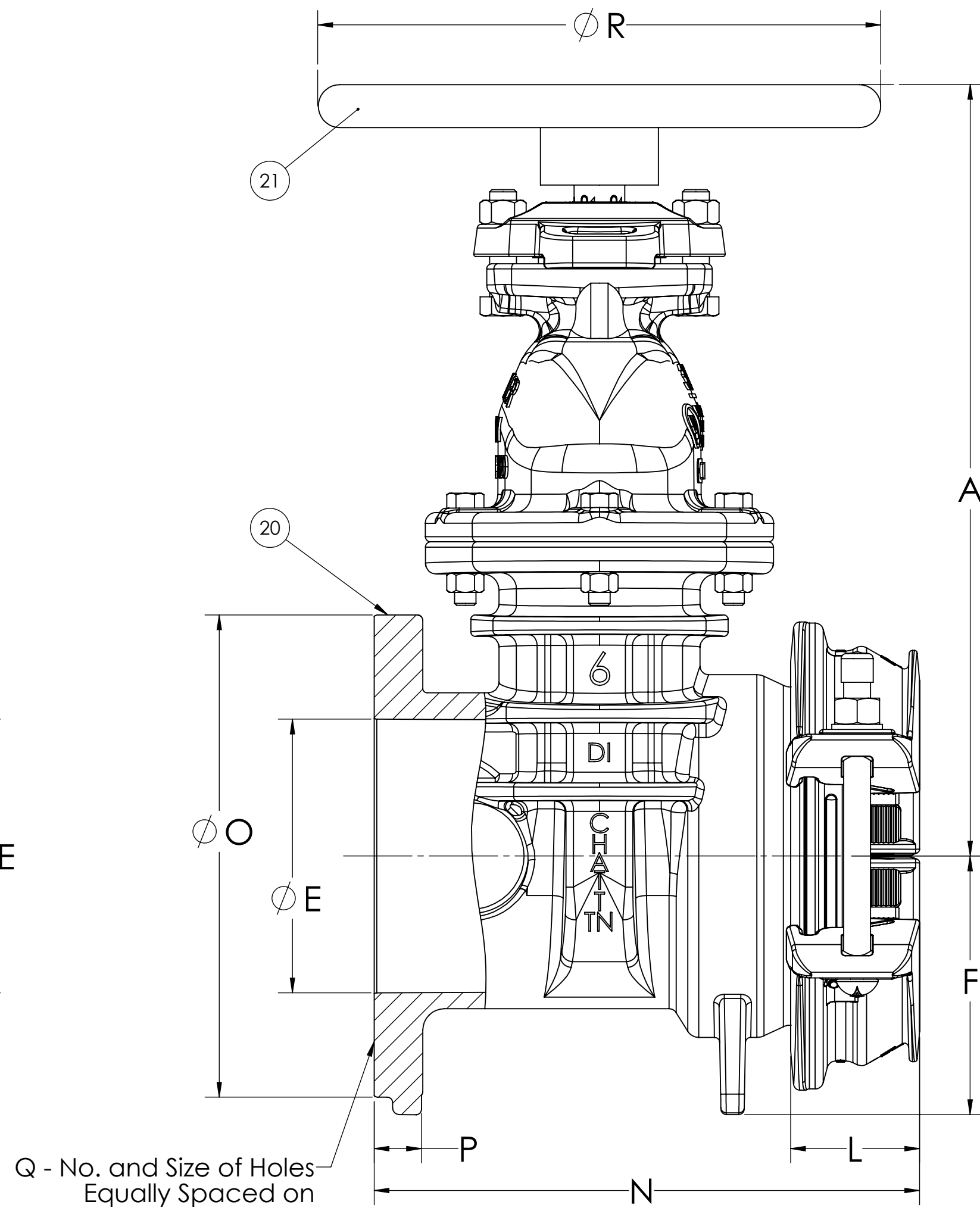

HYMAX / FLANGE END - HM x FL

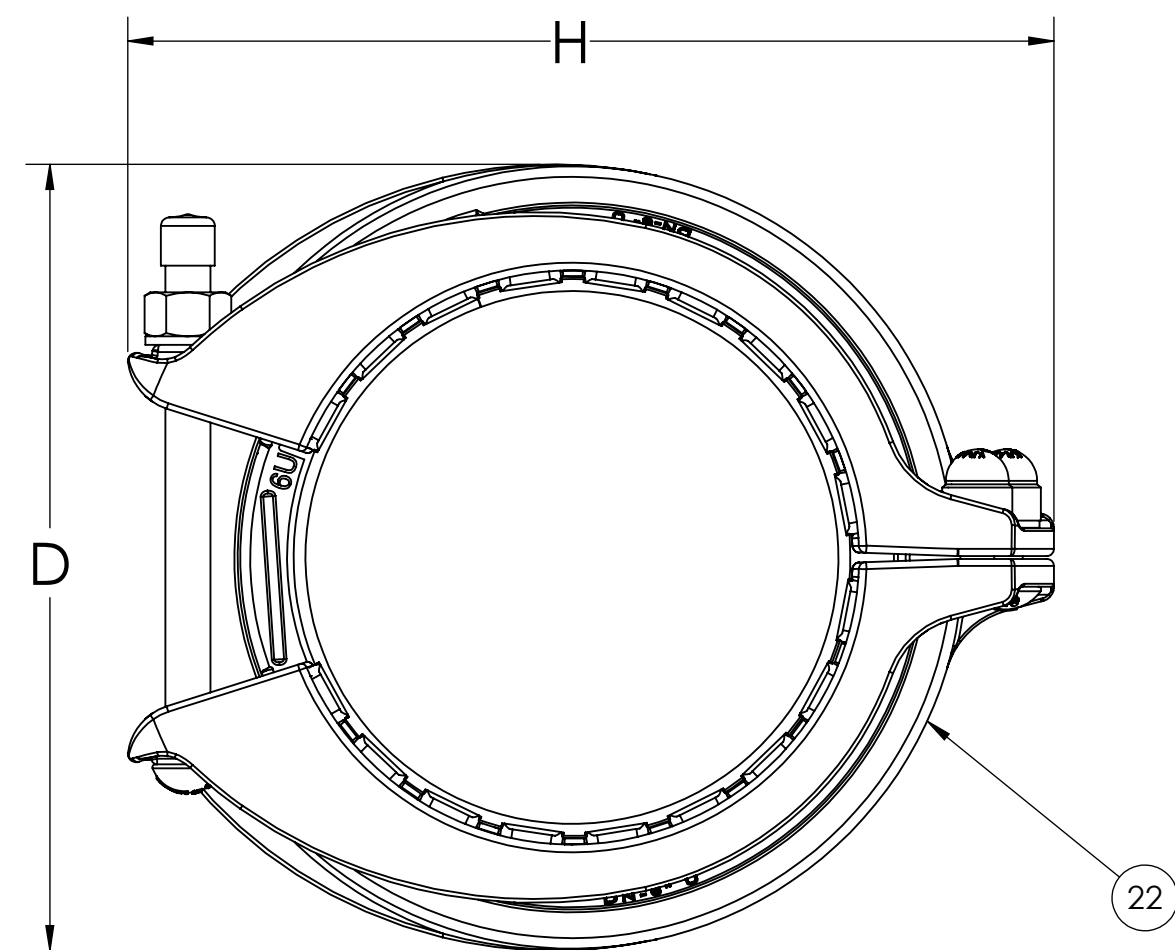

HYMAX GRIP RESTRAINT

| ITEM NO. | DESCRIPTION | B. QTY. | MATERIAL | ASTM | NOTES |
|----------|------------------------|---------|----------------------------|--------------------------|------------------|
| 1 | Cap Screw | 1 | 316 Stainless Steel | F593 | Group 2 - CW |
| 2 | Wrench Nut | 1 | Ductile Iron | A536 | |
| 3 | Stuffing Box | 1 | Ductile Iron | A536 | |
| 4 | Wiper Ring (dirt seal) | 1 | Thermoplastic Polyurethane | D412/ D624 D2240/D792 | HY-52D |
| 5 | Anti-friction Washer | 2 | Acetal | | |
| 6 | Stuffing Box O-Ring | 1 | Nitrile Rubber | D2000 | R34 |
| 7 | Bonnet | 1 | Ductile Iron | A536 | |
| 8 | Stem O-ring | 3 | Nitrile Rubber | D2000 | R34 |
| 9 | Stem | 1 | Bronze | ‡ | See Note |
| 10 | Bonnet O-ring | 1 | Nitrile Rubber | D2000 | R34 |
| 11 | Body HM Ends | 1 | Ductile Iron | A536 | |
| 12 | Stem Nut | 1 | Bronze | B584 | C89833 / NSF 372 |
| 13 | Encapsulated Disc | 1 | ◆ | D2000 | See Note |
| 14 | Disc Casting | 1 | Ductile Iron | A536 | |
| 15 | Guide Cap | 2 | Acetal | | |
| 16 | Stuffing Box Nuts | 2 | 316 Stainless Steel | F594 | Group 2 - CW |
| 17 | Stuffing Box Bolts | 2 | 316 Stainless Steel | F593 | Group 2 - CW |
| 18 | Bonnet Bolts | "M" | 316 Stainless Steel | F593 | Group 2 - CW |
| 19 | Bonnet Nuts | "M" | 316 Stainless Steel | F594 | Group 2 - CW |
| 20 | Body HM x FL Ends | 1 | Ductile Iron | A536 | |
| 21 | Handwheel | | Cast Iron | A126 | Class B |
| 22 | Hymax Grip Restraint | | | | See Product Spec |

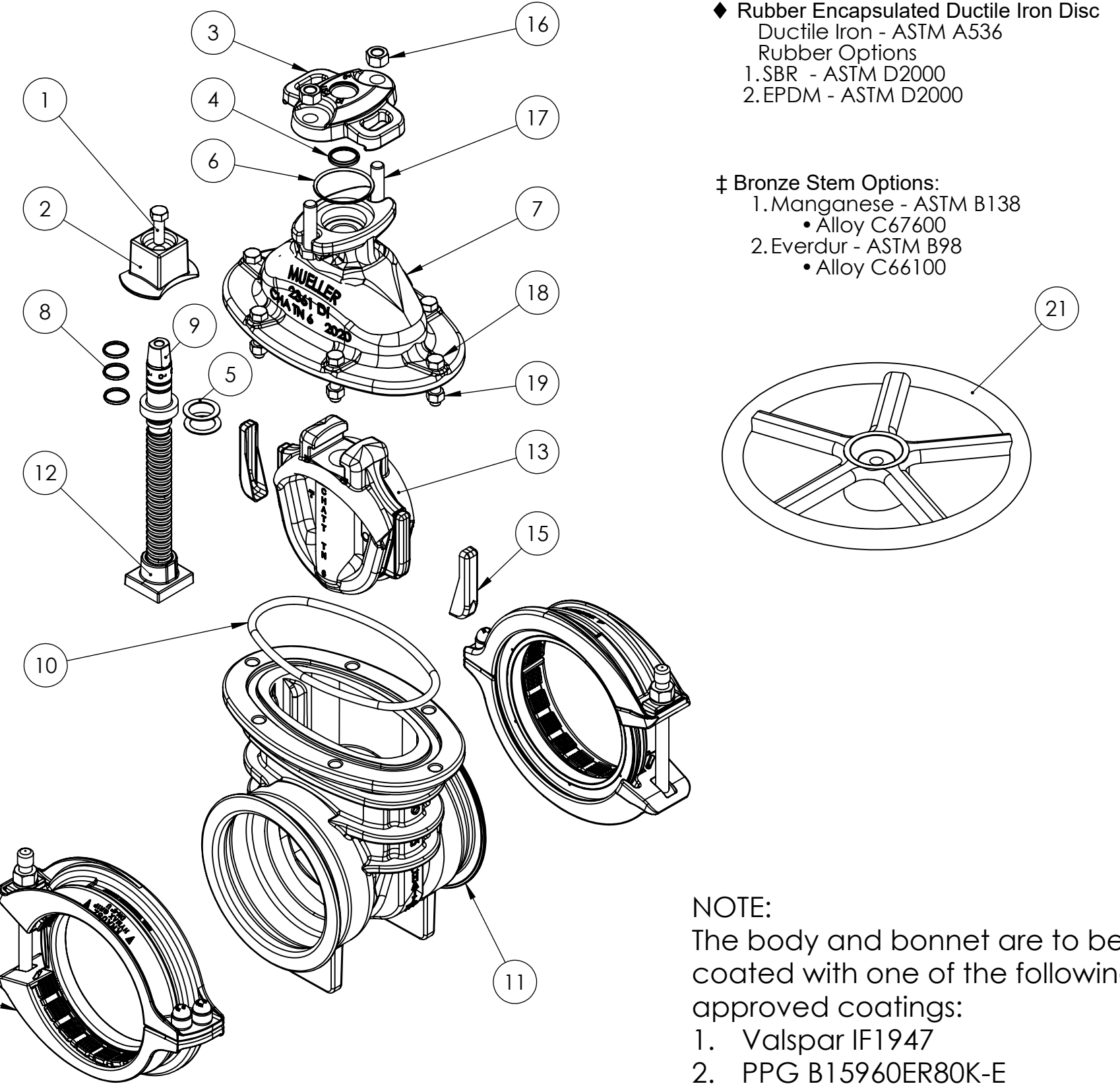

NOTE:
The body and bonnet are to be coated with one of the following approved coatings:
1. Valspar IF1947
2. PPG B15960ER80K-E

ECO# 2493101 **APPROVED**
By Matt Sliger at 9:49 am, Oct 28, 2020

| Valve Size | A | B | C | D | ∅E (Thru ∅) | F | H | L | M | Turns to Open | Weight HM x HM | N | O | P | ∅J (Bolt Circle ∅) | Q | ∅R | Weight HM x FL |
|------------|-------|-------|-------|------|-------------|------|------|-----|---|---------------|----------------|-------|-------|------|--------------------|---------|----|----------------|
| 4 | 14.19 | 14.11 | 10.79 | 8.7 | 4.30 | 4.82 | 10.6 | 3.1 | 4 | 14 | 95 | 11.59 | 9.00 | 1.00 | 7.50 | 8-0.75 | 11 | 90 |
| 6 | 18.00 | 14.91 | 13.5 | 10.9 | 6.30 | 6.03 | 12.9 | 3.1 | 6 | 20.5 | 150 | 12.72 | 11.25 | 1.13 | 9.50 | 8-0.88 | 13 | 147 |
| 8 | 21.50 | 18.74 | 16.36 | 13.8 | 8.30 | 7.33 | 15.7 | 3.5 | 6 | 26.5 | 244 | 15.13 | 13.50 | 1.15 | 11.75 | 8-0.88 | 14 | 223 |
| 10 | 25.50 | 20.14 | 20 | 16.2 | 10.30 | 8.62 | 18.2 | 3.6 | 8 | 33 | 342 | 16.63 | 16.00 | 1.29 | 14.25 | 12-1.00 | 16 | 319 |
| 12 | 28.62 | 20.03 | 21 | 17.4 | 12.30 | 9.59 | 19.8 | 3.6 | 8 | 38.5 | 400 | 17.05 | 19.00 | 1.33 | 17.00 | 12-1.00 | 16 | 419 |

| | | | | | | | | |
|--|--|--------|--|----------------------|-----|------|--|--|
| MUELLER CONFIDENTIAL TITLE TO AND OWNERSHIP OF THIS ENGINEERING DATA REMAINS IN MUELLER CO. NO USE IS TO BE MADE OF THIS DATA EXCEPT AS SPECIFICALLY AUTHORIZED BY MUELLER CO. ASSENT ON THE PART OF THE RECEIPTS TO THESE CONDITIONS IS PRESUMED. | UNLESS OTHERWISE SPECIFIED: DIMENSIONS ARE IN INCHES TOLERANCES: ANGULAR: ± TWO DECIMAL: ± THREE DECIMAL: ± | | | NAME | JAA | DATE | | DESCR. 2361 RWGV 250W with HYMAX GRIP RESTRAINT SIZE DWG. NO. 7618 SCALE: WEIGHT (lbs): SEE TABLE SHEET 1 OF 1 |
| | | | | DRAWN | AO | | | |
| | | | | CHECKED | MS | | | |
| | | | | ENG APPR. | | | | |
| MATERIAL | SEE TABLE | FINISH | | DO NOT SCALE DRAWING | | | | |