

No.	QTY.	DESCRIPTION	MATERIAL	No.	QTY.	DESCRIPTION	MATERIAL
1	1	KEY CAP	CAST BRASS ASTM B62 ALLOY C83600	7	1	SADDLE NUT	CAST BRASS ASTM B62 ALLOY C83600
2	1	PIN	BRASS ASTM B16 ALLOY C36000	8	1	SNAP RING	PHOS BRONZE
3	1	SPRING WASHER	PHOS BRONZE	9	1	RUBBER GASKET	NITRILE ASTM D2000
4	1	O-RING	EPDM ASTM D2000	10	1	PJ CPLG NUT	CAST BRASS ASTM B62 ALLOY C83600
5	1	KEY	CAST LOW LEAD BRASS	11	1	PJ GASKET	ASTM D2000 NITRILE
6	1	BODY	CAST LOW LEAD BRASS	12	1	PJ WASHER	POLYPROPYLENE

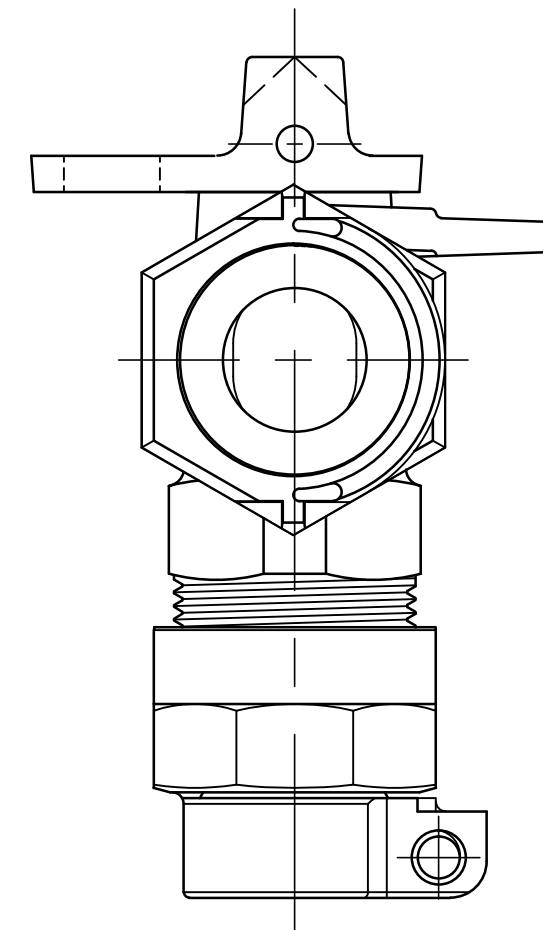
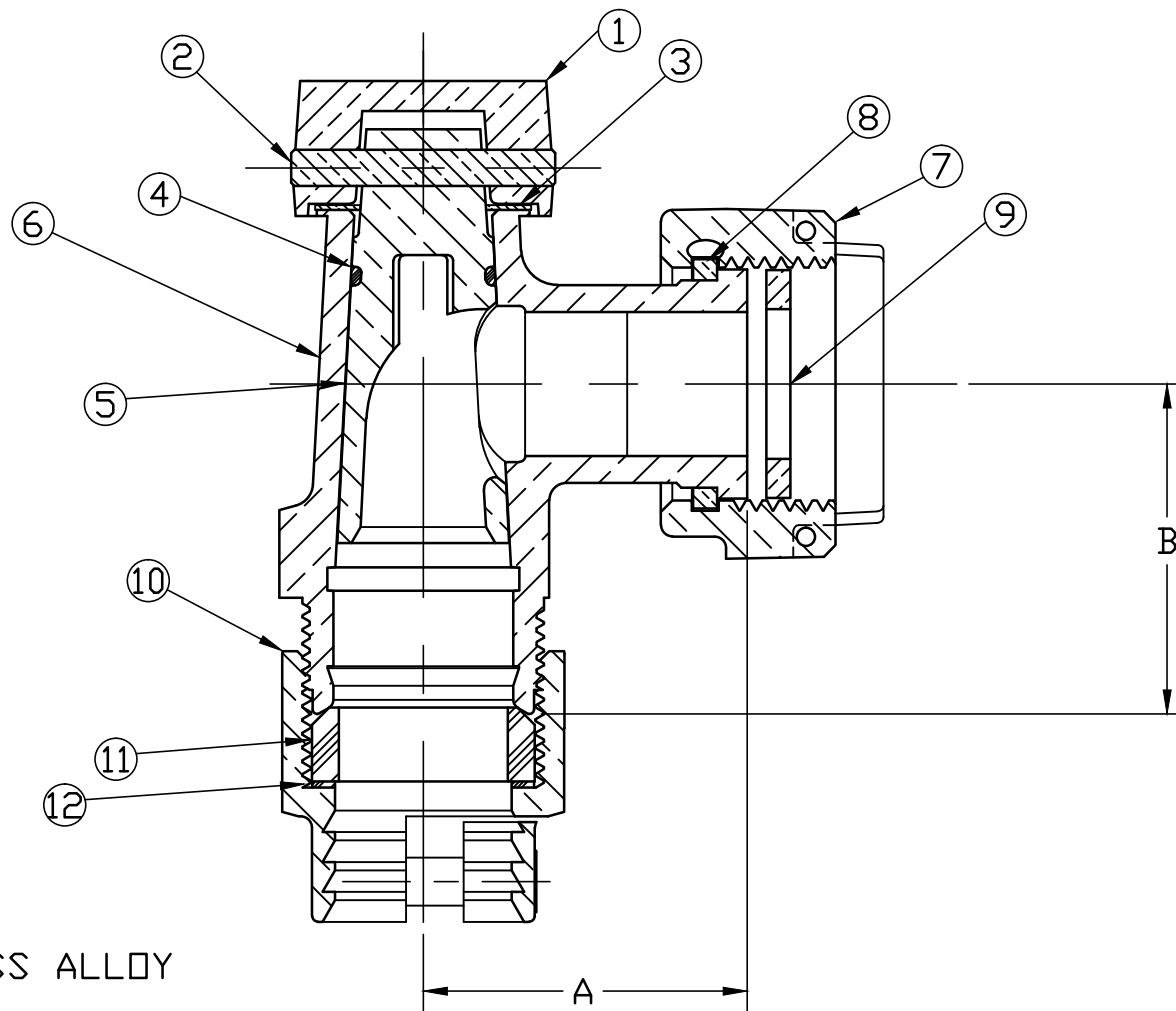

METER CONNX SIZE	A	B
5/8 x 3/4	1-11/16"	1-23/32"
5/8 x 3/4 X 3/4	1-11/16"	1-23/32"
5/8 x 3/4 X 1	1-11/16"	1-31/32"
1	1-15/16"	2-1/8"

ALL WETTED PARTS ARE LOW LEAD BRASS ALLOY

FILEPATH: PROD-ENG\MUELLER\APPROVED\P14258N

DRFTR	JGarvir	4/7/09
CHKR		
ENGR		
MGR		

Mueller Co.

UNLESS OTHERWISE NOTED
 SURFACE PREPARATION:
 BREAK CORNER(S) ---- .000
 SURFACE FINISH -- XX RMS
 TOLERANCE(S):
 LINEAR ----- ± .000
 ANGULAR ----- ± 0°00'

THIRD ANGLE PROJECTION

 REF. No. SCALE
 FULL

STK No:

MAT'L:

DESCR. LLB ANGLE METER STOP
 PJ CTS x MTR

DWG NUMBER
 P14258N

TITLE TO AND OWNERSHIP OF THIS ENGINEERING
 DATA REMAINS IN Mueller Co. NO USE IS TO BE
 MADE OF THIS DATA EXCEPT AS SPECIFICALLY
 AUTHORIZED BY Mueller Co. ASSENT ON THE PART
 OF THE RECIPIENT TO THESE CONDITIONS IS PRESUMED

REV	ECR	DESCRIPTION	DATE	BY	CHKR
PER EST NO:	DXXXX	EST FIN WT =	0.0000 lbs		

DWG NUMBER
 P14258N
 442-MRKTG