

TRITON XR-70® BUTTERFLY VALVE

PRODUCT FEATURES

- Conforms to AWWA C504.
- 24" – 144"/DN600 – DN3600.
- Body Style: Standard Flange Ends.
- Pressure Class: AWWA Class 75B (54" – 144"/DN1350 – DN3600) and 150B.
- Replaceable rubber E-Lok seat-in design.
- Optional external injection port.
- Seat material also available in EPDM.
- Flow-through disc on 30"/DN750 and larger.
- Non-metallic bearings.
- V-type Shaft packing.
- Through disc pinning.

ACCESSORIES/OPTIONS

- Anti-Cavitation Device option to draw in air to reduce cavitation effects
- Bonnets
- Floorstands
- Shaft Locking Devices
- External Epoxy Injection Port
- Expansion Joints
- Rubber Lining

Consult factory for accessory details and optional body styles.

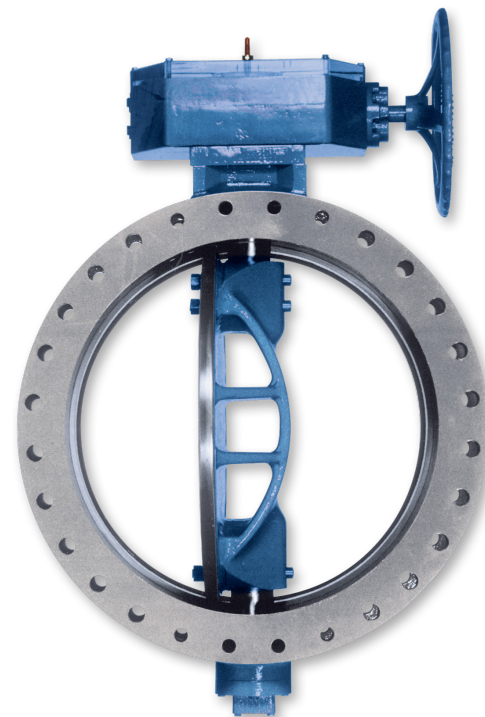

SPECIFICATIONS FOR MATERIAL OF CONSTRUCTION

PART NAME	MATERIAL
Body	Cast Iron (24" – 48"/DN600 – DN1200) – ASTM A126, Class B; Ductile Iron (54"/DN1350 & Larger) – ASTM A536, Grade 65-45-12
Disc	Ductile Iron – ASTM A536, Grade 65-45-12
Disc Edge	Stainless Steel – ASTM A-240 Type 316
Shaft	304 Stainless Steel — ASTM A276 Type 304
Bearing	TLFB — Teflon lined, Fiberglass backed

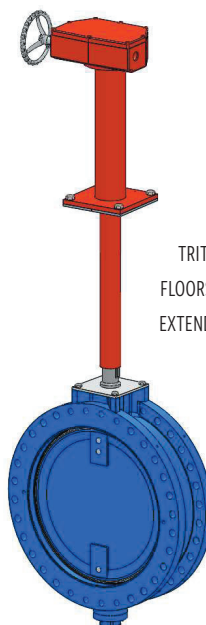

TRITON XR-70
FLOORSTAND WITH
EXTENDED BONNET

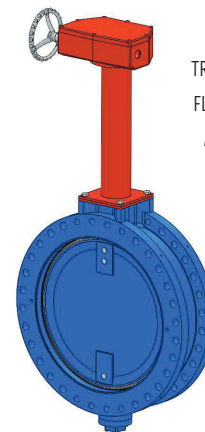

TRITON XR-70
FLOORSTAND
ASSEMBLY

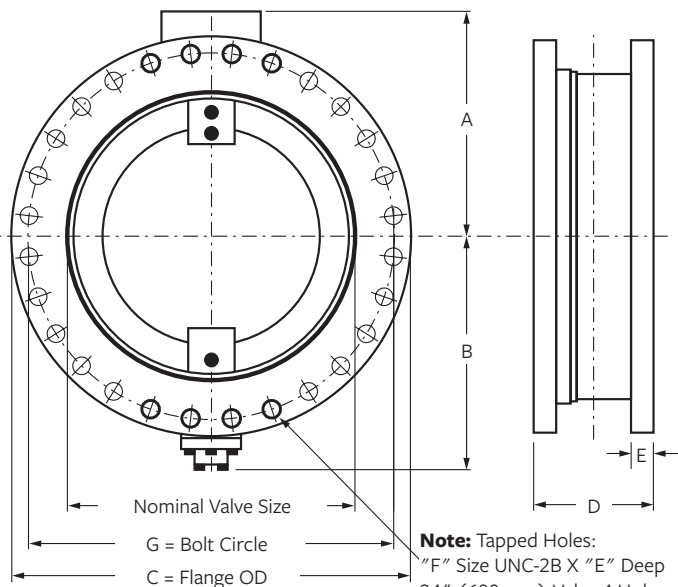

Note: Tapped Holes:
 "F" Size UNC-2B X "E" Deep
 24" (600 mm) Valve 4 Holes – 2 Top & 2 Bottom,
 30" (750 mm) & Up Valve 8 Holes – 4 Top & 4
 Bottom Each Flange.

NOTES

- Size = Nominal valve size.
- For bolts smaller than 1 $\frac{3}{4}$ " (44 mm) in diameter, bolt holes will be $\frac{1}{8}$ " (3 mm) larger than diameter of bolts. For bolts 1 $\frac{3}{4}$ " (44 mm) in diameter and larger, bolt holes will be $\frac{1}{4}$ " (6 mm) larger than diameter of bolts. Dimensions and drilling of end flanges conform to ANSI B16.1 Standard for Cast Iron flanges.
- Allow 3 $\frac{1}{2}$ " (89 mm) for thrust bearing removal.
- A, B = Apply to AWWA Classes 75A, 75B.
- AA, BB = Apply to AWWA Class 150B.
- F = Number and size of bolts. Class 125. Holes in trunnion area are tapped (see Note: Tapped Holes).
- The Triton XR-70 Butterfly Valve can be equipped with a wide range of cylinder actuators and electric motor actuators to meet your special operating requirements. Please consult our factory for additional information.

DIMENSIONS - INCHES (MM)

VALVE SIZE	A	B	AA	BB	C	D	E	NO.-ØF	G
24"/DN600	—	—	18 $\frac{3}{8}$ (473)	18 $\frac{3}{8}$ (467)	32 (813)	8 (203)	1 $\frac{7}{8}$ (48)	20-1 $\frac{1}{4}$ (32)	29 $\frac{1}{2}$ (749)
30"/DN750	21 $\frac{1}{16}$ (548)	22 $\frac{3}{4}$ (578)	21 $\frac{1}{2}$ (546)	24 $\frac{1}{8}$ (613)	38 $\frac{3}{4}$ (984)	12 (305)	2 $\frac{1}{8}$ (54)	28-1 $\frac{1}{4}$ (32)	36 (914)
36"/DN900	25 $\frac{1}{16}$ (637)	26 $\frac{1}{2}$ (673)	25 $\frac{7}{16}$ (626)	28 (711)	46 (1168)	12 (305)	2 $\frac{3}{8}$ (60)	32-1 $\frac{1}{2}$ (38)	42 $\frac{3}{4}$ (1086)
42"/DN1050	29 $\frac{1}{16}$ (738)	30 $\frac{3}{8}$ (772)	29 $\frac{7}{8}$ (759)	32 $\frac{11}{16}$ (830)	53 (1346)	12 (305)	2 $\frac{5}{8}$ (67)	36-1 $\frac{1}{2}$ (38)	49 $\frac{1}{2}$ (1257)
48"/DN1200	32 $\frac{5}{16}$ (821)	34 $\frac{5}{8}$ (879)	34 $\frac{1}{16}$ (865)	36 $\frac{5}{8}$ (937)	59 $\frac{1}{2}$ (1511)	15 (381)	2 $\frac{3}{4}$ (70)	44-1 $\frac{1}{2}$ (38)	56 (1422)
54"/DN1350	36 $\frac{1}{8}$ (918)	38 $\frac{1}{2}$ (978)	37 $\frac{1}{2}$ (952)	40 $\frac{11}{16}$ (1033)	66 $\frac{1}{4}$ (1683)	15 (381)	3 (76)	44-1 $\frac{3}{4}$ (44)	62 $\frac{3}{4}$ (1594)
60"/DN1500	39 $\frac{5}{8}$ (1006)	42 $\frac{1}{16}$ (1068)	41 $\frac{3}{4}$ (1060)	45 $\frac{5}{16}$ (1148)	73 (1854)	15 (381)	3 $\frac{1}{8}$ (79)	52-1 $\frac{3}{4}$ (44)	69 $\frac{1}{4}$ (1759)
66"/DN1650	43 $\frac{1}{16}$ (1106)	46 $\frac{3}{4}$ (1187)	46 $\frac{1}{16}$ (1170)	49 $\frac{1}{2}$ (1257)	80 (2032)	18 (457)	3 $\frac{3}{8}$ (86)	52-1 $\frac{3}{4}$ (44)	76 (1930)
72"/DN1800	46 $\frac{15}{16}$ (1192)	55 $\frac{5}{8}$ (1413)	50 (1270)	53 $\frac{5}{8}$ (1349)	86 $\frac{1}{2}$ (2197)	18 (457)	3 $\frac{1}{2}$ (89)	60-1 $\frac{3}{4}$ (44)	82 $\frac{1}{2}$ (2095)

DIMENSIONS - INCHES (MM)

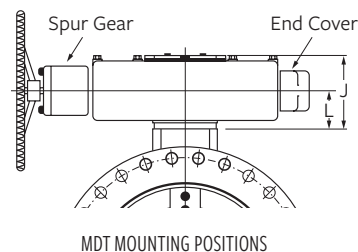
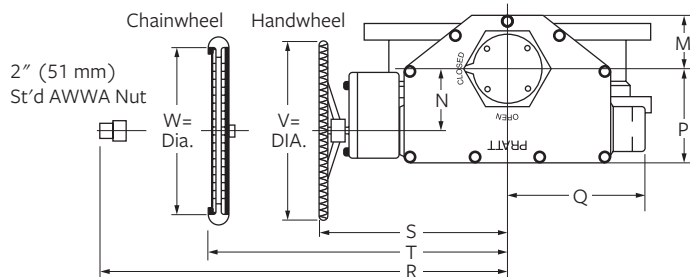

MDT SIZE	J	L	M	N	P	Q
MDT-3	7 $\frac{3}{4}$ (197)	4 $\frac{1}{16}$ (103)	3 $\frac{1}{4}$ (83)	3 $\frac{5}{22}$ (82)	5 $\frac{5}{8}$ (143)	5 $\frac{3}{8}$ (137)
MDT-4	8 (203)	4 $\frac{1}{2}$ (114)	3 $\frac{3}{8}$ (86)	4 (138)	7 $\frac{5}{16}$ (186)	6 $\frac{3}{4}$ (171)
MDT-5	10 (254)	5 $\frac{5}{8}$ (143)	4 $\frac{1}{2}$ (114)	5 $\frac{1}{2}$ (140)	8 $\frac{3}{4}$ (222)	10 $\frac{1}{2}$ (267)
MDT-5S	10 $\frac{3}{4}$ (273)	6 $\frac{1}{8}$ (156)	5 $\frac{5}{8}$ (143)	7 (191)	10 $\frac{5}{8}$ (270)	15 $\frac{15}{16}$ (405)
MDT-6S	12 $\frac{7}{8}$ (327)	7 $\frac{5}{8}$ (194)	7 (267)	8 $\frac{1}{4}$ (210)	12 $\frac{5}{8}$ (321)	18 $\frac{5}{8}$ (473)

MDT SIZE	R	S	T	ØV	ØW
MDT-3	9 $\frac{1}{4}$ (235)	10 $\frac{1}{2}$ (267)	10 (254)	12 (305)	9 $\frac{1}{8}$ (232)
MDT-4	10 $\frac{1}{2}$ (267)	11 $\frac{1}{2}$ (292)	11 (279)	12 (305)	9 $\frac{1}{8}$ (232)
MDT-5	17 (432)	17 $\frac{1}{8}$ (435)	17 $\frac{7}{8}$ (454)	18 (457)	16 $\frac{1}{16}$ (418)
MDT-5S	19 $\frac{11}{16}$ (500)	20 (508)	20 $\frac{3}{4}$ (527)	24 (610)	22 $\frac{1}{4}$ (565)
MDT-6S	26 $\frac{1}{2}$ (673)	26 $\frac{3}{4}$ (679)	25 $\frac{7}{8}$ (657)	24 (610)	22 $\frac{1}{4}$ (565)

Note:

- Clockwise to close (open left) unless otherwise specified.
- Spur gear and end cover apply only to MDT6S.

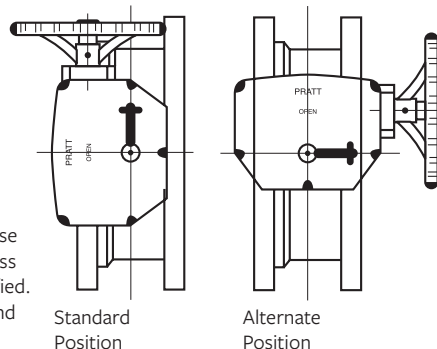

For more information about us, or to view our full line of products, please visit www.mueller-international.com or call International Customer Service at:

UK: +44.1438.487410 Dubai: +971.4.214.6640 Singapore: +65.6816.3088 USA: +1.800.423.1323 | International@muellerwp.com

Mueller refers to one or more of Mueller Water Products, Inc., a Delaware corporation ("MWP"), and its subsidiaries. MWP and each of its subsidiaries are legally separate and independent entities when providing products and services. MWP does not provide products or services to third parties. MWP and each of its subsidiaries are liable only for their own acts and omissions and not those of each other. MWP brands include Mueller®, Echologics®, Hydro Gate®, Hydro-Guard®, Jones®, Krausz®, Mi.Net®, Milliken®, Pratt®, Pratt Industrial®, Singer®, and U.S. Pipe Valve & Hydrant. Please see muellerwp.com/brands to learn more.

© 2020 Mueller Water Products, Inc. All Rights Reserved. The trademarks, logos and service marks displayed in this document are the property of Mueller Water Products, Inc., its affiliates or other third parties. Products above marked with a section symbol (§) are subject to patents or patent applications. For details visit www.muellerwp.com.