

ITEM NO	PART NUMBER	QTY	DESCRIPTION	MATERIAL
1	215B2426551RN	2	5/8" X 3/4" REDUCED PORT BALL VALVE	LEAD FREE BRASS ALLOY ASTM B584 C89833/C87850
2	215HI4222	2	3/4" MULTI-PURPOSE X 3/4" FIP TAIL PIECE	LEAD FREE BRASS ALLOY ASTM B584 C89833/C87850
3	532076E	1	METER BAR 3/4" MULTI-PURPOSE LLB	LEAD FREE BRASS ALLOY ASTM B584 C89833/C87850
4	680003E	2	RISER SUB ASSEMBLY	COPPER ALLOY C12200

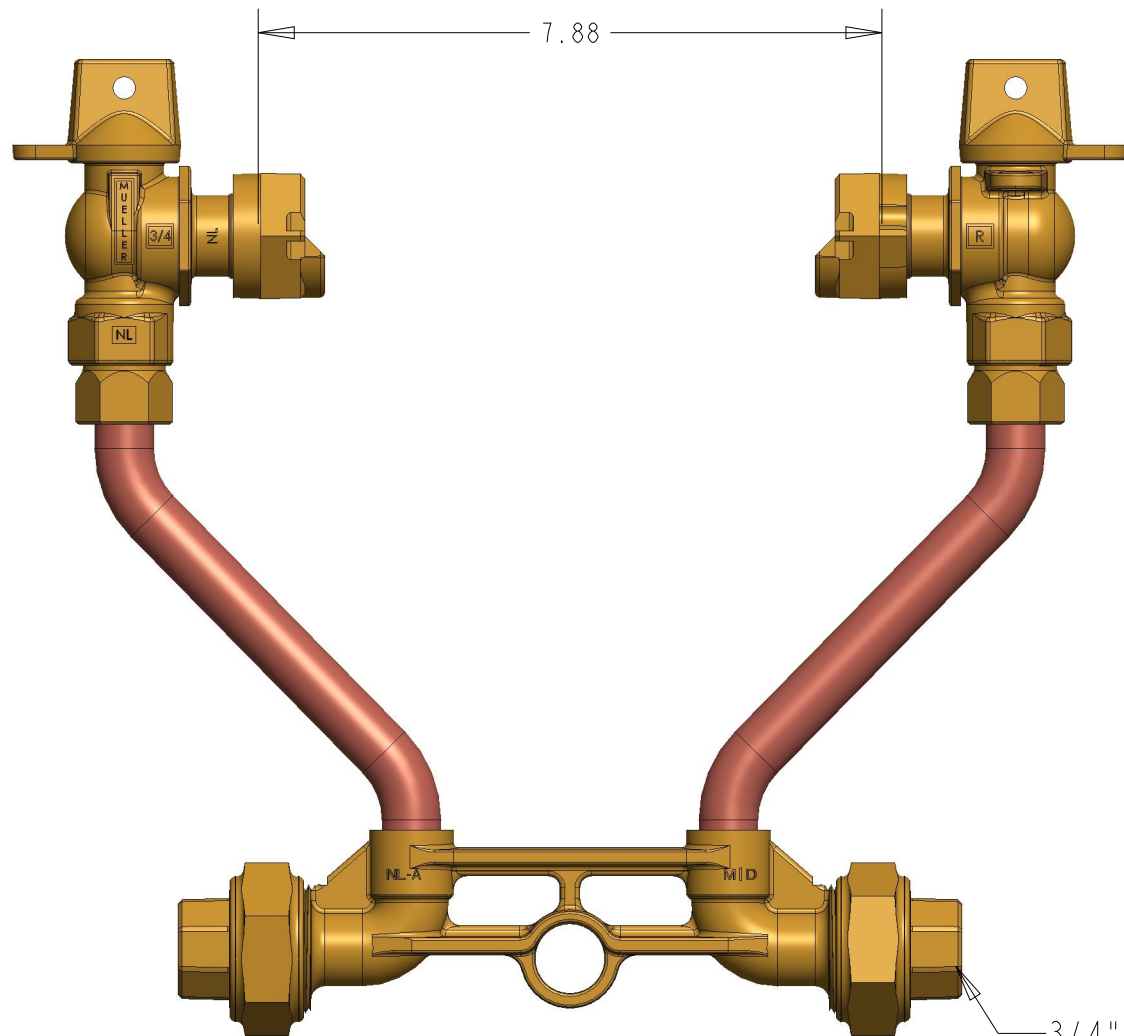

3/4" FIP THREADS
INLET & OUTLET

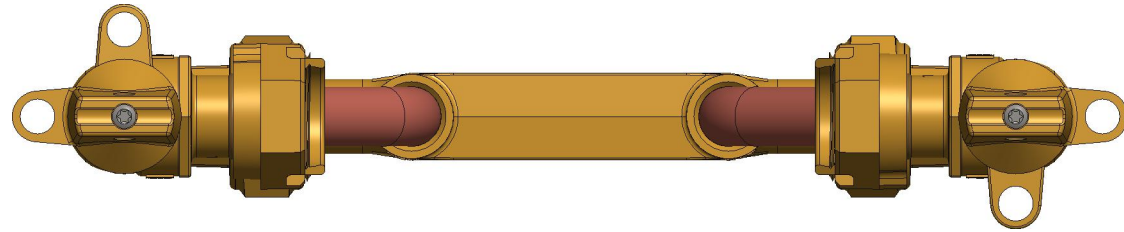
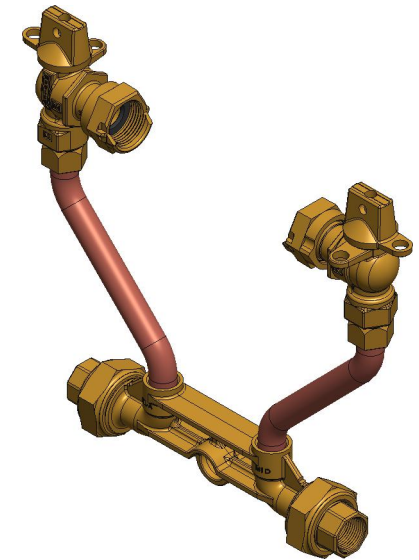

OPTION CODE: 29
 * BALL VALVE ON INLET & OUTLET
 * HI4222 INSTALLED ON INLET & OUTLET

DR. BY	BBF	4/28/17	UNLESS OTHERWISE NOTED	THIRD ANGLE PROJECTION	C.B. NO.
CHKR			BREAK CAST CORNER(S)---		
ENGR			BREAK MACH CORNER(S)---	PURCH.	PATT. NO.
MGR			TOLERANCES	FINISH	
MFG			UNLESS OTHERWISE NOTED	REF. NO.	SCALE
TOOL			LINEAR	±	NONE
FDRY			ANGULAR	±	STK. NO.

MAT'L:		DESCR.	NUMBER
		5/8" X 3/4" COPPER METER SETTER 9" RISER HEIGHT LOW LEAD BRASS	236B2404-R--29N

236B2404-R--29N