

ITEM NO	PART NUMBER	QTY	DESCRIPTION	MATERIAL
1	330B24265N	1	1" FULL PORT BALL VALVE	LEAD FREE BRASS ALLOY ASTM B584 C89833/C87850
2	532221E	1	1" HORIZONTAL METER BAR WITH BRACING EYE *LLB*	LEAD FREE BRASS ALLOY ASTM B584 C89833/C87850
3	581832E	1	RISER SUB ASSEMBLY W/ SADDLE NUT	COPPER ALLOY C12200
4	680054E	1	10" RISER SUB ASSEMBLY	COPPER ALLOY C12200

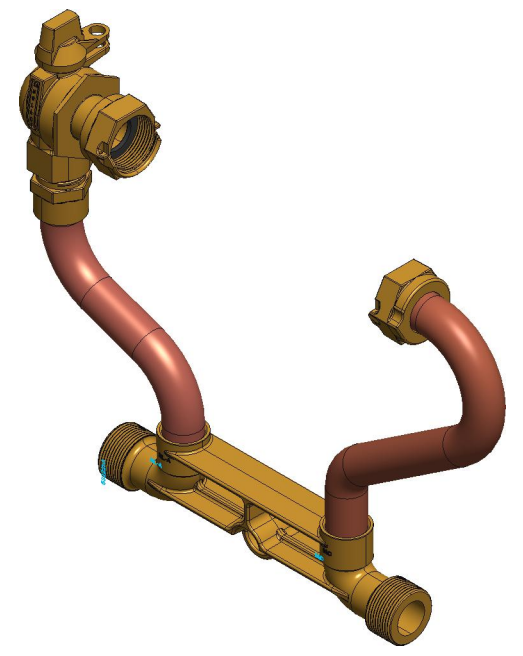
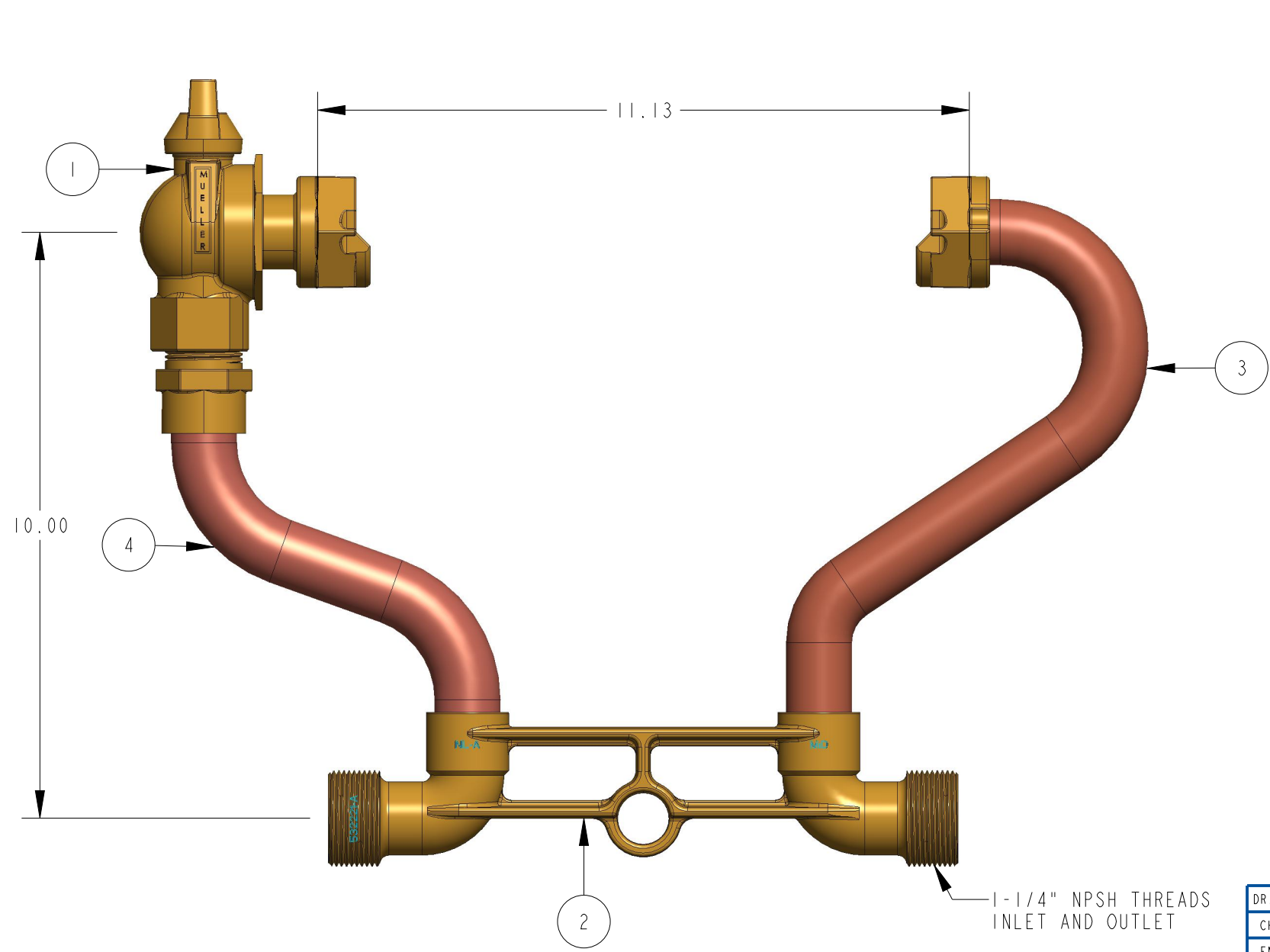

389B24118-----N

DR. BY	AOS	1/19/24	UNLESS OTHERWISE NOTED	THIRD ANGLE PROJECTION	C.B. NO.
CHKR			BREAK CAST CORNER(S)---		
ENGR			BREAK MACH CORNER(S)---	PURCH.	FINISH
MGR			TOLERANCES	REF. NO.	PATT. NO.
MFG			UNLESS OTHERWISE NOTED	SCALE	NONE
TOOL			LINEAR	ANGULAR	
FDRY			±	±	STK. NO.
MAT'L:					
MUELLER			DESCR. 1" COPPER METER SETTER 10" RISER HEIGHT LEAD FREE BRASS	NUMBER 389B24118-----N	