

DWG NUMBER
B20298

NO.	DESCRIPTION	MATERIAL
1	LEVER HANDLE	CAST BRASS ALLOY ASTM B584
2	MACH SCREW	TYPE 304 STAINLESS STEEL
3	HEX LOCKNUT	TYPE 18-8 STAINLESS STEEL

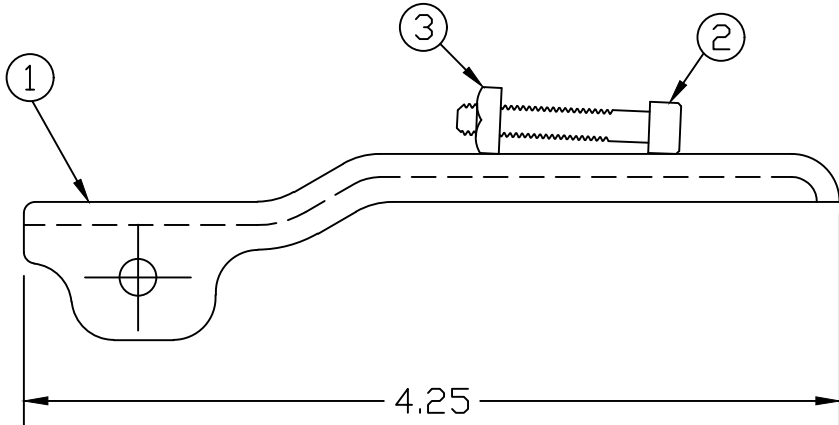

MEETS ALL REQUIREMENTS OF AWWA C800
 ALL WETTED PARTS ARE LEAD FREE BRASS ALLOY C89833/C87850
 ALL NON WETTED PARTS ARE BRASS ALLOY C83600/C87850

DRFTR	AD	02/08/23
CHKR		
ENGR		
MGR		
	BY	DATE

MUELLER

UNLESS OTHERWISE NOTED
 SURFACE PREPARATION:
 BREAK CORNER(S) ---- .000
 SURFACE FINISH -- XX RMS
 TOLERANCE(S):
 LINEAR ----- ± .000
 ANGULAR ----- ± 0°00'

THIRD ANGLE PROJECTION	
REF. No.	SCALE
	FULL

MAT'L:

DESCR. BALL VALVE LEVER HANDLE
W/ SCREW AND NUT

DWG NUMBER
B20298

TITLE TO AND OWNERSHIP OF THIS ENGINEERING
 DATA REMAINS IN Mueller Co. NO USE IS TO BE
 MADE OF THIS DATA EXCEPT AS SPECIFICALLY
 AUTHORIZED BY Mueller Co. ASSENT ON THE PART
 OF THE RECIPIENT TO THESE CONDITIONS IS PRESUMED